

THE HONORS TRANSFER COUNCIL OF CALIFORNIA

proudly presents

the 25th annual

BUILDING BRIDGES RESEARCH CONFERENCE

University of California, Riverside

April 5, 2025



Featuring students of the member colleges of the
Honors Transfer Council of California

2025 CONFERENCE COMMITTEE

Erik Ozolins, Mt. San Jacinto College

Joachin Arias, LA Harbor College

Christina Yamanaka-Vu, Mt. San Jacinto College

Nathan Lopez, Compton College

Ruth Blandón, East Los Angeles College

Evan Kendall, Los Angeles City College

Emily Liu, Irvine Valley College

Judy Cannon, Crafton Hills College

Stella Setka, West Los Angeles College

Christina Axtell, Santa Ana College

Brian Kennedy, Pasadena City College

Delores Loedell, MiraCosta College

Alannah Rosenberg, Saddleback College

Tim Adell, Victor Valley College

HTCC Conference Chair

HTCC Conference Co-Chair

HTCC President

HTCC Treasurer

Conference Communication Co-Chair

Conference Communication Co-Chair

Conference Program Chair

Poster Coordinator

Scholarship Committee Chair

Conference Registration Chair

Moderator Co-Coordinator

Moderator Co-Coordinator

Moderator Co-Coordinator

Building Bridges Editor

Welcome

Welcome to the 25th annual Building Bridges Research Conference. The Honors Transfer Council of California, in partnership with the University of California, Riverside, is honored to be part of this conference, which highlights the research produced by community college honors students from across the state of California. This conference started over two decades ago with a small number of presentations by students from a handful of colleges. It has grown over the years in size and quality, and today we welcome hundreds of students, faculty, administrators, and guests to participate in a community of learning and to celebrate the academic accomplishments of our presenters. We are thrilled to continue our partnership with UC Riverside, especially University Honors, and are grateful to our hosts for this opportunity to showcase the research of honors community college students from across the state of California.

Today you will hear about innovative research from a wide array of disciplines. This conference is a unique opportunity to attend presentations and participate in discussions not only in your own area of specialization, but also in academic fields with which you are less familiar. In the spirit of honors education that embraces intellectual discovery and supporting interdisciplinary approaches to research, learning, and problem solving, we invite you to attend a diversity of sessions that are listed in this program. We hope you will come away from the conference enriched with knowledge you may not have otherwise obtained. Please also be sure to attend the closing plenary session of the conference, where prizes will be awarded to students with outstanding abstracts and posters and to students who have demonstrated outstanding growth and academic success through their involvement in their community college's honors program.

As honors students, you represent some of the best qualities of your respective colleges, reflecting not only your own hard work and academic excellence but also the teaching and mentoring of those who have made a difference in your life. We hope you will embrace your role as an unofficial ambassador of your school, network with honors students from other institutions, and take a few minutes to walk around and experience the UCR campus once the conference is over as you consider your future transfer options.

From all the members of the Honors Transfer Council of California, we wish you an educational and enjoyable conference.

Christina Yamanaka-Vu

President, Honors Transfer Council of California

Professor of History and Honors Program Co-Director, Mt. San Jacinto College

Erik Ozolins

Vice President and Conference Chair, Honors Transfer Council of California

Professor of Anthropology and Honors Program Co-Director, Mt. San Jacinto College

Gratitude and Thanks

The Honors Transfer Council of California sincerely thanks the administration and staff of the **University of California, Riverside University Honors Program** for their invaluable support of this annual research conference. UC Riverside's commitment to our organization and this event reflects its strong dedication to California community colleges and transfer students.

To learn more about UC Riverside University Honors, please visit honors.ucr.edu.

We extend our deepest appreciation to **Dr. Begoña Echeverria**, Faculty Director of UC Riverside University Honors; **Aaron Bushong**, Administrative Director of UC Riverside University Honors; and **María Rosa**, University Honors Counselor, for their tremendous assistance in making this conference possible.

We owe special thanks to the faculty who read and scored hundreds of abstracts:

Tim Adell, Victor Valley College

Joachin Arias, Los Angeles Harbor College

Michael Bobo, Norco College

Chase Dimock, College of the Canyons

Amy Fredericks, Long Beach City College

Carol Impara, Mt. San Antonio College

Evan Kendall, Los Angeles City College

Emily Liu, Irvine Valley College

Allison Murray, Long Beach City College

Erik Ozolins, Mt. San Jacinto College

Edward Pineda-Castro, Los Angeles City College

Michael Plotkin, Mt. San Jacinto College

Areej Qasqas, Citrus College

Carlos Rosales, Los Angeles Harbor College

Stella Setka, West Los Angeles College

Jeff Wheeler, Long Beach City College

Rachel Williams, El Camino College

Christina Yamanaka-Vu, Mt. San Jacinto College

Cameron Young, Norco College

To the faculty who read and scored submissions for HTCC scholarships and abstract awards:

Tim Adell, Victor Valley College

Jeanene Ames, West Los Angeles College

Elena Avilés, West Los Angeles College

Anthony Cuomo, West Los Angeles College

Pam Fife, West Los Angeles College

Brian Kennedy, Pasadena City College

Melissa King, San Bernardino Valley College

Tiffany Lanoix, West Los Angeles College

Rick Mayock, West Los Angeles College

Jennifer Ortiz, West Los Angeles College

Erik Ozolins, Mt. San Jacinto College

Zeneida Parente Alves Neta, West Los Angeles College

Alannah Rosenberg, Saddleback College

Sandra Ruiz, West Los Angeles College

Stella Setka, West Los Angeles College

Kathryn Turley-Sonne, Cypress College

Jeff Wheeler, Long Beach City College

Cameron Young, Norco College

And to the faculty judges who scored submissions for outstanding posters:

Judy Cannon, Crafton Hills College

Steven Chang, LA Harbor College

Laura Greathouse, Riverside Community College

Michael Levine, San Bernardino Valley College

Amy Mills, San Bernardino Valley College

Jon Mochizuki, Orange Coast College

Anjeanette Oberg, Mt. San Jacinto College

Guck Ooi, Cerro Coso College

Karen Ortiz, LA Harbor College

Michael Plotkin, Mt. San Jacinto College

Nick Reeves, Mt. San Jacinto College

Lindsay Weiler, Crafton Hills College

Gratitude and Thanks

Finally, special thanks goes to

Christina Yamanaka-Vu, whose leadership of HTCC enhances the quality of honors programs across the state.

Erik Ozolins and **Joachin Arias** for coordinating all the moving pieces of this conference.

Emily Liu for facilitating review of submitted abstracts and creating the conference program.

Ruth Blandón and **Evan Kendall**, who sent important communications to student researchers.

Judy Cannon for coordinating review of posters.

Stella Setka for facilitating review of scholarship and award applications.

Brian Kennedy, **Delores Loedell**, and **Alannah Rosenberg** for coordinating our student moderators.

Christina Axtell for managing conference registration.

Tim Adell, who will edit the 2025 edition of *Building Bridges* so that our students can share their research with the wider world.

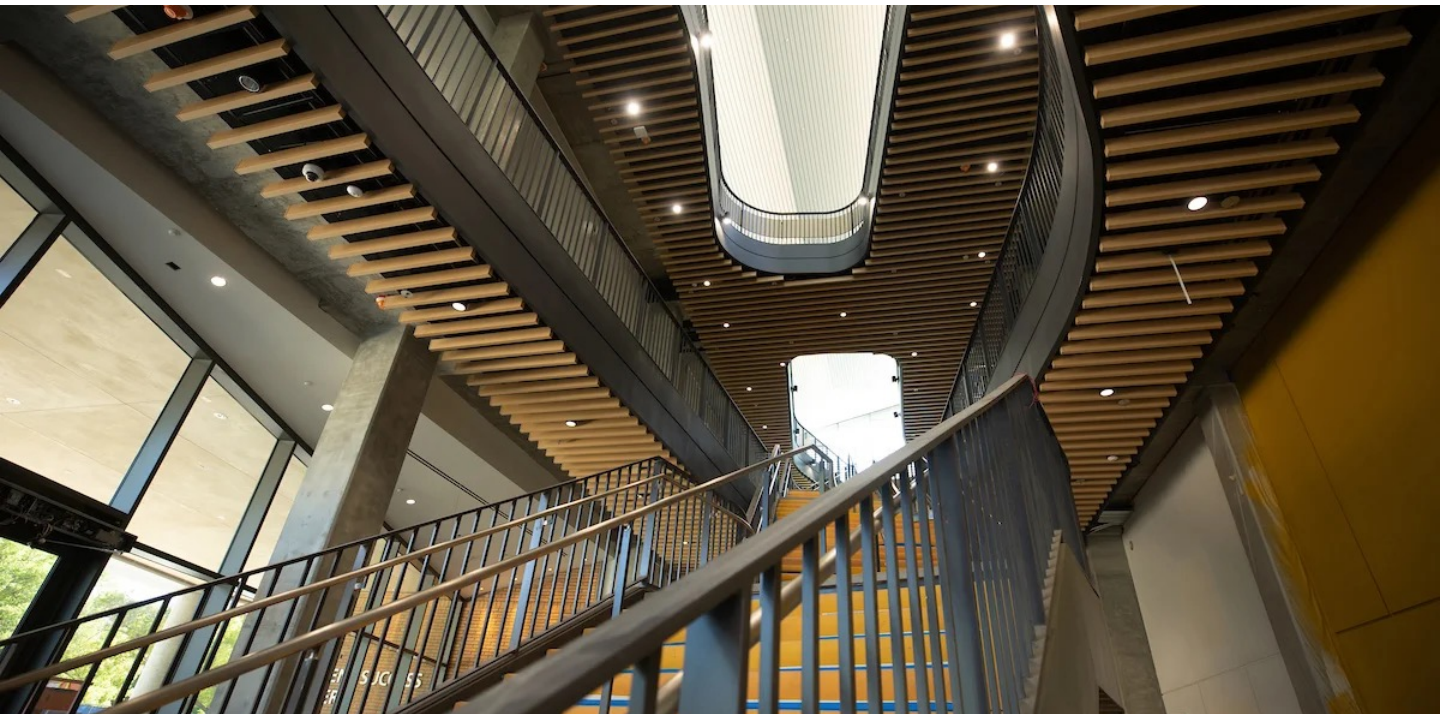

25th Annual Building Bridges Research Conference

PROGRAM

7:15-8:00	Registration & Breakfast	HUB 1 st floor entryway
8:00-8:40	Opening Plenary	HUB 302
8:50-9:30	Session 1A: Poster Presentations A	SSC 1 st & 2 nd floors
9:40-10:20	Session 1B: Poster Presentations B	SSC 1 st & 2 nd floors
10:30-11:45	Session 2: Oral Presentations	HUB & SSC classrooms
11:45-12:45	Lunch UC Riverside Campus Resources	HUB Plaza
12:45-2:00	Session 3: Oral Presentations	HUB & SSC classrooms
2:15-3:30	Session 4: Oral Presentations	HUB & SSC classrooms
3:45-4:30	Closing Plenary / Awards	HUB 302



UC Riverside Highlander Union Building (HUB)

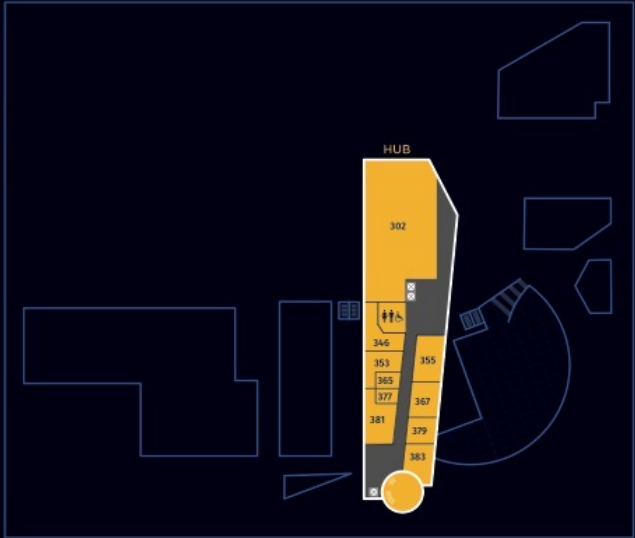

LEVEL 3
HUB

- 302, 355, 367, 379 PROGRAMMING/CONFERENCE ROOM
- 346 R'PANTRY
- 353 HUB ADMINISTRATION
- 365 UC IMMIGRANT LEGAL SERVICES
- 377 CAMPUS ADVOCACY, RESOURCES & EDUCATION (CARE)
- 383 GRADUATE STUDENT LOUNGE



LEVEL 2
HUB

- 202 ASSOCIATED STUDENTS
- 203 GRADUATE STUDENT ASSOCIATION
- 221 SENATE CHAMBER
- 228 STUDENT ORGANIZATION WORK ROOM
- 229 STUDENT LIFE
- 248 THE WELL
- 260, 265, 268, 269 CONFERENCE ROOMS
- 261 TRIO SCHOLARS
- 272 COMMUTER & TRANSFER LOUNGE

COSTO HALL

- 224 UNDOCUMENTED STUDENT PROGRAMS (USP)
- 228 MEDITATION ROOM
- 229 NATIVE AMERICAN STUDENT PROGRAMS (NASP)
- 241 HILLEL
- 244 ASIAN PACIFIC STUDENT PROGRAMS (APSP)
- 245 LGBT RESOURCE CENTER (LGBTRC)
- 260 WOMEN'S RESOURCE CENTER (WRC)

UC Riverside Student Success Center (SSC)

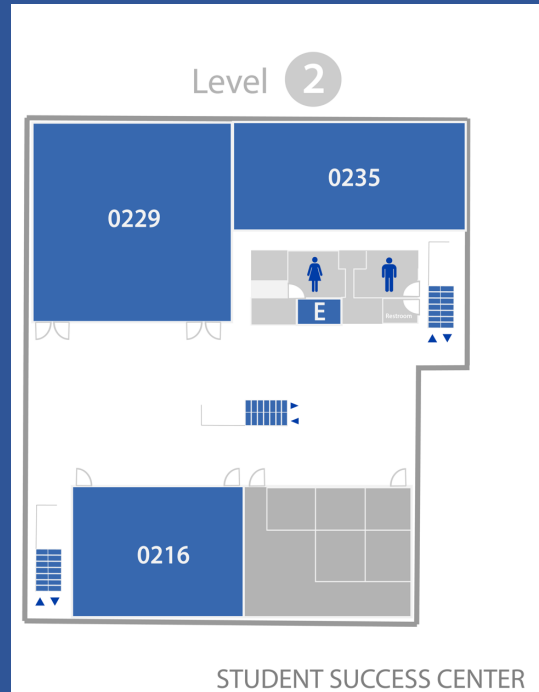
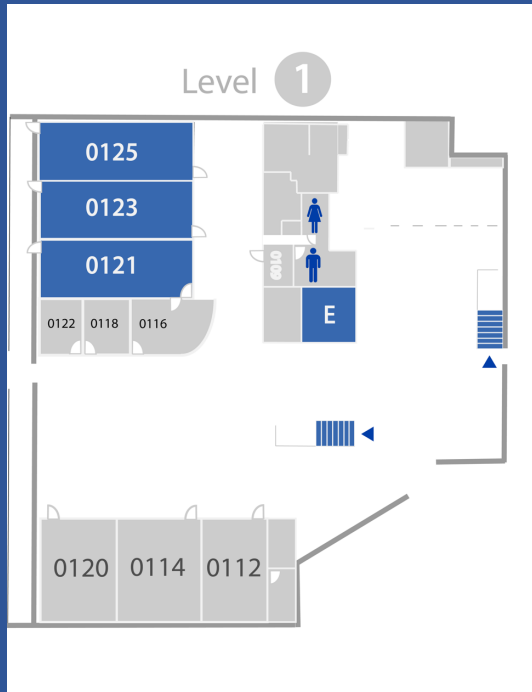



Opening Plenary 8:00-8:40 am

HUB 302

WELCOME AND INTRODUCTIONS

Christina Yamanaka-Vu

President, Honors Transfer Council of California
History Professor, Mt. San Jacinto College

Erik Ozolins

Vice President, Honors Transfer Council of California
Anthropology Professor, Mt. San Jacinto College

Dr. Louie F. Rodriguez

Vice Provost and Dean of the Division of
Undergraduate Education, University of California,
Riverside

Dr. Begoña Echeverria

Howard H Hays, Jr. Chair and Faculty Director of
University Honors, University of California, Riverside

Donna Arteaga Alvarez

Current University Honors Transfer Student, University
of California, Riverside

Session 1A: Poster Presentations A

8:50-9:30 am

SSC 1st Floor

A1	<p>Kisha Meta Cypress College Mentor: Kathryn Sonne</p>	<p>Gender-Specific Mechanisms in Alzheimer's Disease: A Multimodal Analysis of Clinical and Neuroimaging Data Investigating gender disparities in Alzheimer's Disease with statistical and non-linear models to analyze clinical, demographic, and neuroimaging data, uncovering predictive factors and confounding relationships.</p>
A2	<p>David Tolman Elisabeth Spaid Los Angeles City College Mentor: Sean Phommasaysy</p>	<p>A Delicate Balance: Ecologically Conscious Larvicide This study evaluates household solutions as mosquito larvicides, revealing linseed oil as an eco-friendly, effective alternative that balances larval control with plant health preservation.</p>
A3	<p>Isaac Serrato Mt. San Antonio College Mentor: Diana Churchill</p>	<p>Rethinking Root Canal Sealer: Analyzing the Potential Replacement of Calcium Hydroxide-based Endodontic Sealers with Chlorhexidine -based Endodontic Sealers This study compared chlorhexidine and calcium hydroxide as endodontic antibacterial agents, finding no statistically significant difference, though chlorhexidine qualitatively showed better bacterial reduction.</p>
A4	<p>Nayeli Alejandra Zermeno Moreno Valley College Mentor: Kanya Godde Chrisco</p>	<p>Comparison and Accuracy of the Phenice (1969) and Klaes et al. (2012) Methods for Sex Identification Through the Pelvis Phenice (1969) and Klaes et al. (2012) are compared using the same database to determine which is most accurate. Phenice proved to be more accurate.</p>
A5	<p>Genesis Sandoval Pasadena City College Mentors: Brian Kennedy and Michael Vendrasco</p>	<p>Counting Carbon: Unpacking the Complex Dynamics of CO₂ Emissions & Sequestration in Native Californian Landscapes Carbon counting that solely credits native plants oversimplifies and neglects the complexities of accurately quantifying carbon dynamics in both aboveground and belowground interactions.</p>
A6	<p>Alfina Eull El Camino College Mentor: Teresa Palos</p>	<p>Battling Bacterial Biofilms: The Disruptive Potential of Probiotics The resistance that bacterial biofilms have towards antibiotics is frightening, but possible inhibitors like probiotics hold promising potential.</p>

Session 1A: Poster Presentations A

8:50-9:30 am

SSC 1st Floor

A7	<p>Hala Naji Riverside City College Mentor: Alejandro Cortez</p>	<p>How 5-Hydroxytryptophan Can Model the Benefits of Utilizing Non-Canonical Amino Acids to Improve Anti-Depressant Medication I will attempt to find methods of improving antidepressants by analyzing how non-canonical amino acids can interfere with biochemical processes, modeled by 5-Hydroxytryptophan.</p>
A8	<p>Fady Hanna Hannah Rosario Mt. San Jacinto College Mentor: Nick Reeves</p>	<p>Annotation of the Insulin-Like Peptide 3 (Ilp3) Gene in Drosophila busckii Using gene annotation, findings from two fruit flies, <i>Drosophila melanogaster</i> and <i>Drosophila busckii</i>, showed evidence of evolutionary differences between their Ilp3 genes.</p>
A9	<p>Spencer Song David Liese Mt. San Antonio College Mentor: Tim Revell</p>	<p>Bacteria Bonanza: Bacteria in Dog Park Water Bowls The water in dog water bowls at dog parks were compared to human drinking fountains and were found to contain a higher quantity of bacteria.</p>
A10	<p>Kristine Chai Merilynn Chai Irvine Valley College Mentor: Victor Pham</p>	<p>Engineered Extracellular Vesicles to Mitigate Cellular Senescence-Associated Secretory Phenotype Through Targeted mRNA Delivery in Human Primary Cells Investigation of engineered exosomes loaded with anti-senescence mRNA to reduce senescence-associated secretory phenotype as a therapeutic approach for managing cellular senescence and age-related pathological processes.</p>
A11	<p>Chelsea Chan Hideharu Suzuki El Camino College Mentor: Shawn McEachin</p>	<p>Microbiomes in the Human Gut and their Effects on our Mood Feeling moody? Explore how your gut microbiomes can affect your everyday thinking.</p>
A12	<p>Leonard Gea Irvine Valley College Mentor: Meredith Dorner</p>	<p>Electroacupuncture: A Promising Non-Pharmacological Approach for Hypertension Management Hypertension affects millions, yet control rates remain low. Discover how electroacupuncture, targeting nerves and inflammation, offers a promising non-drug therapy for this "silent killer."</p>

Session 1A: Poster Presentations A

8:50-9:30 am

SSC 1 st Floor		
A13	<p>Azaan Asad Las Positas College Mentor: Federico Lopez Borghesi</p>	<p>The Therapeutic Efficacy of Medicinal Plants versus Conventional Pharmacological Interventions in Lung Cancer Treatment: A Systematic Review This systematic review evaluates plant versus drug treatment efficacy to improve patient outcome and quality of life.</p>
A14	<p>Jazmyn Garcia Crafton Hills College Mentors: Cory Kunkel and Krysten Audibert</p>	<p>Genetics, Epigenetics, and the Environment: Unraveling the Complexities of Mental Health Disorders This project examines how genetic predispositions and epigenetic modifications interact to influence mental health outcomes, providing insights from existing studies on their combined effects.</p>
A15	<p>Fernanda Velasco Irvine Valley College Mentors: Amir Ahsan and Matthew Powell-Palm</p>	<p>An Isochoric Optical Platform for Interrogation of Aqueous Glass Formation Processes Interrogation of aqueous glass formation processes, utilizing dynamic light intensity (DLI) and constant light intensity (CLI) techniques in a new isochoric chamber design.</p>
A16	<p>Pranav Arora Chaffey College Mentor: Julie Song</p>	<p>Computerized Simulation of Projectile Motion This paper contrasts idealized projectile motion with real-world trajectories, exploring the effects of air resistance, drag, lift, and Magnus effect through computerized simulations and analysis.</p>
A17	<p>Nathanael Atkins MiraCosta College Mentor: Juan Castillejos</p>	<p>Exploring Methods for Numerical Integration Many real world problems require solving complex integrals. To solve these problems numerical integration is used. We explore using machine learning to perform numerical integration.</p>
A18	<p>Sydney Hoang Sana Vosoughi Irvine Valley College Mentor: Lan Pham</p>	<p>A Study of the Twin Prime Gap in the Twin Prime Conjecture in Number Theory Analyzing statistics of twin prime gap to provide new insights on the twin prime conjecture.</p>
A19	<p>Grace Lee Fullerton College Mentor: Vani Khamo</p>	<p>AI Gender Bias: How Algorithms Reflect Inequality An exploration of how AI unintentionally reinforces gender bias through facial recognition, natural language processing, and AI-generated imagery, emphasizing the need for fair and inclusive design.</p>

Session 1A: Poster Presentations A

8:50-9:30 am

SSC 2nd Floor

A21	<p>Hayk Atanasyan Sophia Davis Pasadena City College Mentor: Rebecca Johannsen</p>	<p>The Future of Sustainable Supply Chain Strategies in the Fashion Industry This paper examines what the fashion industry must prioritize in innovative sourcing and supply chains to effectively promote environmental responsibility and ethical economic growth.</p>
A22	<p>Xander Brown Irvine Valley College Mentor: Mark Collinson</p>	<p>The Jones Act: An Examination of the Cost of Living in Hawai'i The costs of living in Hawai'i are exorbitant, and the Jones Act causes Hawaiians to suffer for the benefit of a long-dead American shipping industry.</p>
A23	<p>Kaitlyn Tsai El Camino College Mentors: Rachel Williams and Meric Keskinel</p>	<p>Escaping Poverty: Financial Literacy and Socioeconomics This project aims to highlight the ties between cultural norms and socioeconomic factors along with their corresponding impact on financial literacy.</p>
A24	<p>Elissa Ferguson Mt. San Jacinto College Mentor: John Torres</p>	<p>A Look at Death Positivity Through Children's Films Americans have used the film industry as a means of helping to positively discuss death and topics within it, with their children.</p>
A25	<p>Yuji Miao Pasadena City College Mentors: Krista Walter and Bradford Johnston</p>	<p>Journey to the West: How Tang Poetry influenced American Poetry and Society Tang poetry had influenced American poetry in different poetic aspects creating a successful pattern of cultural communication and absorption that could promote greater cultural development.</p>
A26	<p>Shubhangi Waldiya Danny Abraham El Camino College Mentor: Karl Striepe</p>	<p>The Role of Media in War: Understanding How Public Support is Created This presentation examines how media and propaganda manipulate public perception to fuel support for war, analyzing both historical and contemporary conflicts.</p>

Session 1A: Poster Presentations A

8:50-9:30 am

SSC 2nd Floor

A27	<p>Emily Oh Nathaniel Cho Kareem Airood Irvine Valley College Mentors: Lan Pham and Amir Ahsan</p>	<p>Beyond a One-Night Stand: The Perpetual Relationship Between Hook-Up Culture and Dating Apps in the Spread of STIs Among American Youth Hook-up culture and dating apps, fueling easy access to casual sex contributes to growing STI rates among youth, highlighting the need for preventative measures.</p>
A28	<p>Marlon Cuaya Moreno Valley College Mentor: Kanya Godde Chrisco</p>	<p>The Inequality of Death: Examining Demographic Disparities in Black Death Mortality This project investigates the impact of age and sex on mortality during the Black Death using skeletal data from medieval London cemeteries.</p>
A29	<p>Tharushi Henagama Irvine Valley College Mentor: Deanna Scherger</p>	<p>Accessibility to Affordable Housing in California and Governmental Policies This research examines California's affordable housing crisis, exploring its causes, impacts, and potential solutions, which include legislative reforms and housing development initiatives by relevant authorities.</p>
A30	<p>Hamza El Lahib Citrus College Mentor: Jennifer Miller-Thayer</p>	<p>Screams of Change: Deathcore's Revival and Its Potential for Youth Mobilization Exploring Deathcore music's journey from Myspace to modern platforms, this paper dives into its cultural struggles, political themes, and ways to support its growing revival.</p>
A31	<p>Bernard Kahiga West Los Angeles College Mentor: Tiffany Lanoix</p>	<p>The Growing Diversity of Black America Race is a social construct rooted in the creation of the Americas. I examine the history, identity, classification, and evolving diversity of Blackness in America.</p>

Session 1A: Poster Presentations A

8:50-9:30 am

SSC 2nd Floor

A32	Yazil Lara Padilla Los Angeles City College Mentor: Brian Bartelt	The Link Between Animal Ritualized Behavior and Creation Of Cargo Cults Animal ritualized behavior has been an adaptive trait for human rituals, eventually leading to the creation of cargo cults through acculturation, ritual and symbolism.
A33	Fatema Sayed Moreno Valley College Mentor: James Bany	Discrimination of Middle Eastern Refugees Presents key ideas and informs the public about the discrimination and struggle of Middle Eastern refugees.
A34	Brian Delama Citrus College Mentor: Erin Tate	Mitigating the Long-Term Psychological and Developmental Impact of Divorce on Children Parental divorce profoundly impacts children's mental health, cognitive development, and relationships. This research explores these effects and advocates proactive strategies to mitigate lasting adversities.
A35	Nuha Hussain Las Positas College Mentor: Robin Roy	Hue You Are: How Colors Affect Emotions and Moods Feeling cheerful from a sunset or down on dreary days? Discover how colors speak to us through our emotions from this study at Las Positas.
A36	Anthony Soliman Chaffey College Mentor: Melissa DiLorenzo	Altruism: What is it and How Do Humans Manifest It? This project explores how culture and genetics impact varying degrees of altruism in humans.

Session 1B: Poster Presentations B

9:40-10:20am

SSC 1 st Floor		
B1	<p>Cristhal Mencias El Camino College Mentor: Karla Villatoro</p>	<p>Five Second Rule: The Effects of Early Exposure to Microbes on Children's Immunity Children's early exposure to microbes has been shown to strengthen their immune system, reducing the risk of developing allergies among other autoimmune diseases.</p>
B2	<p>Josue Garnica Los Angeles Harbor College Mentor: Joachin Arias</p>	<p>Microplastics in Marine Life: How Much and How Worse Can It Get? By 2050, the amount of microplastic debris in the ocean will significantly outweigh the amount of marine life in the ocean. Is that prediction true?</p>
B3	<p>Roice De Castro Mt. San Jacinto College Mentors: Lilia Briones and Michael Plotkin</p>	<p>Investigating pH-Sensitive Alginate Capsules for Controlled Release: Addressing GERD with Targeted Drug Delivery This study evaluates pH-sensitive sodium alginate capsules for controlled drug delivery, showcasing potential to revolutionize GERD treatment by improving targeting precision and reducing side effects.</p>
B4	<p>Maryam Mian El Camino College Mentor: Darcie McClelland</p>	<p>Endocrine-Disrupting Chemicals: Why Are They in Your Beauty and Self-Care Products? People are exposed to endocrine-disrupting chemicals because of the unregulated beauty/skincare industry. This project highlights health risks involved, helping individuals make informed, safe purchases.</p>
B5	<p>Tyler Kim MiraCosta College Mentor: Jeff Ihara</p>	<p>Comparative Analysis of Bacterial Flagella Structure and Its Role in Motility Across Species This project investigates how bacterial flagella structure across species influences their motility patterns and adaptation to different environmental conditions.</p>
B6	<p>Valeria Lara West Los Angeles College Mentor: Vered Mirmovitch</p>	<p>Medicinal Usage of California Sagebrush This project examines how indigenous people historically used California Sagebrush (<i>Artemisia californica</i>) for medicinal purposes and argues for its incorporation into Western medicine.</p>

Session 1B: Poster Presentations B

9:40-10:20am

SSC 1st Floor

B7	<p>Carley Kubler El Camino College Mentor: Karla Villatoro</p>	<p>Worming Your Way to Better Skin: The Planaria Model for Cell Regeneration This project explores how chitin, honey, and hyaluronic acid could enhance skin regeneration by studying planarian tissue repair, opening new doors for human wound-healing treatments.</p>
B8	<p>Kaden Vu John Huynh Medelen Nguyen Orange Coast College Mentor: Amy Hellman</p>	<p>Mitigation of Algal Blooms through Modified Clays Aims to mitigate growing issue of harmful algal blooms using chemically modified clays that will bind to algae.</p>
B9	<p>Meihui Zhu Haonan Chen Mt. San Antonio College Mentor: Diana Churchill</p>	<p>Sleepy or Sharp: The Impact of Sleep Duration on Reaction Time This study explores the relationship between sleep duration and reaction time, revealing no significant differences between individuals sleeping more or fewer than six hours.</p>
B10	<p>Shannon Atkins MiraCosta College Mentor: Linnie Trzoss</p>	<p>An Exploration of the Relationship between Methotrexate Side Effects and the MTHFR c.677C>T Polymorphism This review covers what research has found regarding the correlation between the MTHFRc.677C>T mutation and methotrexate toxicity.</p>
B11	<p>Hinanui Swider Emmanuel Hernandez Irvine Valley College Mentor: Kristen Skjonsby</p>	<p>The Implementation of AI in the Field of Anesthesiology This study evaluates AI in anesthesiology by comparing dosage recommendations, risk predictions, and monitoring advice to practicing anesthesiologists, demonstrating AI's potential to improve patient safety.</p>

Session 1B: Poster Presentations B

9:40-10:20am

SSC 1st Floor

B12	<p>Audrey Qi Ryan Tan Mt. San Antonio College Mentor: Diana Churchill</p>	<p>Why I Should Sleep: Impact of Sleep Quality and Quantity on Short-Term and Working Memory in Community College Students</p> <p>This study analyzes the impact of sleep quality and quantity on short-term and working memory in community college students.</p>
B13	<p>Isabella Lee Irvine Valley College Mentor: My Vo Luong</p>	<p>Nature's Effect on Our Health</p> <p>My project talks about the benefits of spending time in nature and how it benefits our well being.</p>
B14	<p>Artemis Jahansooz Moreno Valley College Mentor: James Bany</p>	<p>The Role of Architecture in Sustainable Urban Development</p> <p>My research explores architecture's role in sustainable urban development, using Masdar City as a model for eco-friendly innovation, renewable energy, efficient design, and community-driven planning.</p>
B15	<p>Lucius Gibbons Irvine Valley College Mentor: Ankita Mohapatra</p>	<p>Building a Neural Network for Autonomous Fire Detection</p> <p>I designed and trained a Neural Network that uses sensor data to automatically detect whether or not a fire is present.</p>
B16	<p>Rohit Kancharla Las Positas College Mentor: Amitesh Maiti</p>	<p>The Calculus of Trust: Blockchain Through the Lens of Mathematics</p> <p>Elucidate the underpinning mathematical concepts that enable Blockchain's decentralized, transparent, and secure operations to exchange value through elementary calculus-based modeling and modular arithmetic.</p>
B17	<p>Madison Le Irvine Valley College Mentor: Kristen Skjonsby</p>	<p>The Battle Against Climate Change: How AI Impacts the Environment</p> <p>This research explores the extent to which artificial intelligence interacts with the environment, discussing potentials for the balance between technological advancement and sustainable development.</p>

Session 1B: Poster Presentations B

9:40-10:20am

SSC 1st Floor

B18	Matthew Castillo Fullerton College Mentor: Jodi Balma	AI and Machine Learning Applications in Bioengineering, AI-driven Engineering of Protein Complexes This study explores the significance of Artificial Intelligence in simulating and engineering protein complex variants, yielding real-world drug resistance and synthetic biology applications.
B19	Matvey Matsko Pasadena City College Mentor: Joann Stock	Optimizing Data Processing: A Step to Unravel Venus' Mysteries Fast Fourier Transform algorithms enhance the signal-to-noise ratio, enabling the detection of specific planetary geological features that can be applied to space exploration.
B20	Emilia A. Ramirez Citrus College Mentors: Jennifer Miller-Thayer and Pablo Benalcazar	The Human Factor: A Missing Link in Energy Systems Engineering For too long, energy systems models have prioritized profits while omitting crucial social factors that affect rural communities and long-term success of rural electrification projects.

Session 1B: Poster Presentations B

9:40-10:20am

SSC 2nd Floor

B21	<p>Yujin Masuda El Camino College Mentor: Tom Cody</p>	<p>Will Artificial Intelligence Take Your Job? How will AI shape the future job market? My presentation explores how automation could displace jobs, transforming industries, but also potentially create new career opportunities.</p>
B22	<p>Varsha Torpunuri Irvine Valley College Mentor: Hailey White</p>	<p>Antitrust Laws in the Field of Mergers and Acquisitions: How Outdated Frameworks Fail to Keep Up with AI Companies, Leading to Monopolization and Threats to Capitalism Examining how outdated antitrust laws fail to regulate early AI mergers and acquisitions, enabling monopolization by companies like Microsoft, stifling competition, and shaping the industry.</p>
B23	<p>Jocelynn De la Trinidad Mt. San Antonio College Mentor: Sierra Powell</p>	<p>Proposition 47: A Shift in California's Criminal Justice Landscape An investigation into California Proposition 47's origins, impacts on the criminal justice system, and how California can expect to see changes Proposition 36 being passed.</p>
B24	<p>Vanessa Wu Aileen Soto Kirsty Cheung Madison Sherrif Michelle Chan Parmis Baroumand Shamsedi Pasadena City College Mentors: Shayda Jalali and Katie Lookholder</p>	<p>Cultural Gender Expectations and Divisions Across Immigrant Communities in the United States Cultural gender expectations, from machismo to Confucian values, can create divisions within immigrant communities of color in the United States, affecting intergenerational understanding.</p>
B25	<p>Trista Lau Mt. San Antonio College Mentor: Carol Impara</p>	<p>Reducing the Stigma: Changing Perspectives of Community College This study examined the changes in Honors student perspectives around community college. Perceptions of academic rigor, inclusiveness, and resources all improved after attending community college.</p>

Session 1B: Poster Presentations B

9:40-10:20am

SSC 2nd Floor

B26	Manuel Pernilla Pasadena City College Mentor: Kathleen Green	Accessibility in Burbank, California: The Intrinsic Relationship between Public Spaces and Inclusion Accessible architecture in public spaces maintains a well-rounded inclusive environment in Burbank, California, through accommodating the diverse needs of its residents.
B27	Hyeryn Kim El Camino College Mentor: Melissa Fujiwara	The Price of Perfection: Exploring the Dark Side of Korean Beauty Culture This research explores the harmful psychological and societal effects of Korean beauty standards, focusing on body image issues, mental health, and the beauty industry's influence
B28	Sara Kabbara Irvine Valley College Mentor: Deanna Scherger	Beyond the Diagnosis: Analyzing the Skyrocketing Costs of Cancer Care and Their Impact on Patients Investigating the high costs of cancer care, this presentation reveals past policies and limited reforms driving the financial crisis facing millions of American cancer patients.
B29	Jonathan Laffey Los Angeles City College Mentor: Evan Kendall	Kill Your Idle: Philosophy, Psychedelics, and the Death of the Default Self Psychedelics disrupt the DMN and enhance the MNS, affirming Descartes' philosophy and Merleau-Ponty's embodied cognition by dissolving the ego and enabling the reconstruction of selfhood.
B30	Marie Beccue Long Beach City College Mentors: Carmen Laguer Díaz and Janine Pliska	Peer Review After the Flood: Navigating the Emergent Disruption of Open Access Publishing in Biological Anthropology Thematic analysis of the language, tenor and function of peer review in biological anthropology as it interacts and evolves alongside emerging open access publishing platforms.

Session 1B: Poster Presentations B

9:40-10:20am

SSC 2nd Floor

B31	<p>Hollie Kim El Camino College Mentor: Mora Mattern</p>	<p>Flying Under the Radar: Behind the Skewed Sex Ratio of Autism Spectrum Disorder This project explores factors that contribute to the underdiagnosis of autism in females compared to males, leading to a skewed sex ratio of 1:3.</p>
B32	<p>Rebekah Sundukovskiy Josias Smit Orange Coast College Mentor: Melissa Ferguson</p>	<p>Effects of Distractions and Divided Attention on Memory Recall and Creation of False Memory The use of short-form content platforms like Tik-Tok while studying leads to the question of whether this induces more false memory recall.</p>
B33	<p>Alyssa Curiel El Camino College Mentor: Melissa Fujiwara</p>	<p>Cultural Competency and Mental Health Services: Access, Willingness, and Resistance Among Latinx Young Adults This qualitative study explores key social, cultural, and individual factors related to accessing mental health services among Latinx young adults.</p>
B34	<p>Citlalli Martinez-Blas Los Angeles City College Mentor: Lauren Hofschneider</p>	<p>Academic Adventures: Investigating Factors That Influence a Growth Mindset in Community College This study explores correlations between sense of belonging, student relationships, teacher relationships and their influence on growth mindset among community college students.</p>
B35	<p>Yash Zumale Tyler Truong Irvine Valley College Mentor: Brandee Idleman</p>	<p>Neural and Behavioral Implications of Loneliness and Peer Interaction on Academic Performance Amid a loneliness epidemic, students face declining academic performance. Neural and behavioral insights can help equip society with strategies that enhance student success.</p>
B36	<p>Dayanara Flores Rio Hondo College Mentor: Melissa Rifino Juarez</p>	<p>Physical Symptoms of Anxiety: Exploring the Connection with Chronic Health Conditions This presentation will examine the overlap between anxiety and chronic health conditions along with implications for diagnosis and treatment</p>

Session 2: Oral Presentations

10:30-11:45 am

HUB 260

Adrian Martinez

Santiago Canyon College
Mentor: Tiffany Gause

An Injection of Feminism

My research was primarily based on several academic journals that spoke about cosmetic procedures and feminism. I also conducted an interview with a nurse injector.

Maya Refua

LA Pierce College
Mentor: Christine Ersig-Marcus

Functions of Fashion as Nonverbal Communication in the Queer Community

What can an outfit tell you? People in the Queer community often utilize fashion as nonverbal communication to practice self-expression, signal identity, and build community.

**Lindsey Ambrosio
Jasmine Vargas**

LA Pierce College
Mentor: Erin Hayes

“Bossy or Assertive?”: Gender Bias in Language

Gendered language shapes perceptions of women's abilities, reinforces stereotypes, and influences career choices, playing a key role in gender discrimination.

Elliot Carlson

Mt. San Jacinto College
Mentors: Erik Ozolins and
Jennifer Baney

Implied Representation of Neurogenderqueer People in Monster Media

Neurogenderqueer (NGQ) individuals lack explicit representation, leading them to seek out implied representation in monster media instead. However, this leads to dehumanization of NGQ people.

Session 2: Oral Presentations

10:30-11:45 am

HUB 265

<p>Loreal Palmer Pasadena City College Mentor: Shane Underwood</p>	<p>A (Gadamerian) Return to Lacan: When Natural and Human Sciences Collide (or Combine?) Psychoanalytic therapy with philosophical hermeneutic influence is a necessary component of bipolar disorder treatment, resituating the disorder within the human sciences as a human problem.</p>
<p>Yuxuan (Flora) Li East Los Angeles College Mentor: Bryant Horowitz</p>	<p>Integrating Neurobiology and Psychotherapy: A Comprehensive Approach to Treating PTSD Addressing the limitations of standalone psychological therapy, integrating neurobiology and psychotherapy can provide a more effective approach to treating PTSD.</p>
<p>Celia Tahmasian Emily Markarian Glendale College Mentor: Michael Harnett</p>	<p>The Importance of Positive Human Interaction in Early Childhood Development: A Means of Combating Widespread Prevalence of Anxiety Our study will explore how developmental stages in adolescence influence emotional intelligence, aiming to identify effective strategies to reduce rising anxiety in young adults.</p>
<p>Izabella Alvarado Moreno Valley College Mentor: Jennifer Floerke</p>	<p>The Relationship Between Grief and Fear: Exploring the Direct Effects on Interpersonal Communication and Relationships Grief and fear are both intense emotional responses to stressful situations that can negatively impact interpersonal communication and relationships, consequently causing more damage to ourselves.</p>

Session 2: Oral Presentations

10:30-11:45 am

HUB 268

<p>Howie Liang Pasadena City College Mentors: Jacqueline Yu and Nerses Abramyan</p>	<p>The Implications of Artificial Intelligence in Business This research explores the recent advancements of artificial intelligence and its transformative role in revolutionizing businesses across industries, opening doors to endless possibilities</p>
<p>Cameron Sachar El Camino College Mentor: Kassia Wosick</p>	<p>Automating Healthcare: Measuring Efficiency of Artificial Intelligence in Medical Billing This project explores perceptions of Artificial Intelligence from physicians with private practices and the factors contributing to whether they would integrate AI into their practice.</p>
<p>Arjun Manicka Irvine Valley College Mentor: Emily Liu</p>	<p>The Debugging Revolution: Harnessing Artificial Intelligence for Advanced Bug Detection Leveraging AI-driven tools to revolutionize bug detection, streamline game development processes, and enhance software quality, ensuring efficient production and seamless gaming experiences for users.</p>
<p>Justin Puerta Cypress College Mentor: Kathryn Sonne</p>	<p>The Intersection of Artificial Intelligence and Cybersecurity An exploration of machine learning's role in detecting phishing websites by analyzing URL features, offering scalable and effective solutions to enhance cybersecurity.</p>

Session 2: Oral Presentations

10:30-11:45 am

HUB 269

<p>David Ko Eric Yuxuan Fan El Camino College Mentor: Rachel Williams</p>	<p>Examining the Interplay between Procrastination, Behavior, and Emotion This project explores how different emotions and behaviors are related to and affect procrastination. It also describes the effects of procrastination.</p>
<p>Amelia Pagunsan Cypress College Mentor: Kathryn Sonne</p>	<p>The Fallibility of Time Perception: Strategies for Extending Life Subjectively While time perception is subjective and malleable, there exist strategies — such as mindfulness and novelty — that can enhance life satisfaction and extend subjective time.</p>
<p>Raaga Mahesh Coco Kuramoto Daniel Sagrero Irvine Valley College Mentor: Kristen Venegas</p>	<p>Caveman to Corporate: Exploring Psychological Evolutionary Mismatch Between Ancestral Lifestyles and Modern Society Psychological evolutionary mismatches like disrupted circadian rhythms, social isolation, and information overload contribute to mental health challenges, emphasizing ancestral behaviors to mitigate modern vulnerabilities.</p>
<p>Tony Latora Mt. San Jacinto College Mentors: Dan Peace and Julie Peggarr</p>	<p>The Potential Long-Term Psychosocial Effects of COVID-19 Isolation in Adolescents and Emerging Adults: A Mixed-Method Analysis of Life Satisfaction, Social Interaction Anxiety, and Experienced COVID-19 Related Stressors This study investigates perceptions related to wellbeing, social anxiety, and COVID-19 isolation in young adults through a thematic qualitative analysis and a quantitative correlational analysis.</p>

Session 2: Oral Presentations

10:30-11:45 am

HUB 355

<p>Lauren Masuda El Camino College Mentor: Mora Mattern</p>	<p>Color Theory in Media: The Impact on Audience Perception This project analyzes the importance of color theory in media, breaking down each aspect of color and revealing the emotional and psychological implications on viewers.</p>
<p>Yen Tze Chia Pasadena City College Mentor: Shane Underwood</p>	<p>Lured by the Odds: The Rhetoric of Betting in Sports Betting Advertisements Targeting US College Students The glamorization of gambling in sports betting advertisements distorts college students' perceptions of risk and reward, while concealing its financial, psychological and social harms.</p>
<p>Isabella Marcello El Camino College Mentor: Stephanie Burnham</p>	<p>The Price of Influence: Unloading the Hidden Costs of Social Media Marketing Learn about the darker side of influencer marketing: how targeted ads shape desires, distort reality, and harm consumer well-being — especially among vulnerable audiences — while fueling overconsumption.</p>
<p>Halima Ba Saddleback College Mentor: Jessica Budica</p>	<p>How Animals in Children's Clothing Reinforce Gender Stereotypes Examining how gender-stereotypical depictions of animals in children's clothing expose children to and reinforce gender stereotypes.</p>

Session 2: Oral Presentations

10:30-11:45 am

HUB 367

Leovaughn Minasian

Irvine Valley College
Mentor: Marissa Gavin

Roman Society on Citizenship and Property

A qualitative analysis of Roman laws of citizenship and property.

Anna Arreola

MiraCosta College
Mentor: Christopher Sleeper

The Costs of Communism: Ceausescu's Liquidation on Romanian Heritage and Identity

An examination of the destruction and erasure of Romanian cultural heritage and identity under radical modernization policies during Nicolae Ceaușescu's rule.

Ninja Friberg

Irvine Valley College
Mentor: Joon Kil

The Last Danish Colony: Understanding the 1917 Sale of the Danish West Indies

Due to different reasons, Denmark decided to sell the Danish West Indies to The United States in 1917, marking the end of Denmark's colonial empire.

Audrey Wallinder

Mt. San Jacinto College
Mentor: Christina
Yamanaka-Vu

The Hibakusha: A Road to Peace

Hibakusha testimonials challenge standard historical narratives of the bomb and showcase the urgency of activists including 2024 Nobel winner Nihon Hidankyo to abolish nuclear weaponry.

Session 2: Oral Presentations

10:30-11:45 am

SSC GM3

Yuki Ellefson

Long Beach City College
Mentor: Katlyn Greiner

Heritage Conservation and the Discussion around Iconoclasm in the Middle East

The Western view of Islamic iconoclasm is biased. To combat iconoclasm in the Middle East a mixture of global expertise and local practices is necessary.

Lucy Davis

El Camino College
Mentor: Karl Striepe

Find the Connections: Multilingualism as a Mechanism for Empathy-Conscious International Relations

This project explores how the promotion and translation of linguistically diverse International Relations academia promotes empathy in diplomacy.

Mia Sanchez

Saddleback College
Mentor: Anthony Szczurek

Navigating Legal Challenges in International Law: Legitimacy, Threats, and the Erosion of Global Support

Exploring threats to international legal practitioners, declining support efforts, and state-targeted crackdowns on NGOs amid rising authoritarianism and legitimacy challenges.

Alexander Aurich

MiraCosta College
Mentor: Heather Stark

Japan's Forgotten Countryside: Demographic Crisis and Revival Strategies

Explores the factors that contribute to rural population decline and unique regional incentives.

Session 2: Oral Presentations

10:30-11:45 am

SSC MPR 1

Annabelle Chatigny

Mt. San Jacinto College

Mentor: Erik Ozolins

Records Beyond Writing: A Brief Exploration of Exosomatic Memory Systems in Prehistory

This paper explores the way that the false dichotomy of the terms 'history' 'prehistory' devalues other forms of information keeping and enforces Eurocentric ideals.

Devin Dadah

Norco College

Mentor: Michael Bobo

The First Crusades: An Anthropophagic Desire to Devour the Arab World

An in-depth examination into the cannibalism of Arab peoples by Frankish Crusaders through the analysis of fanaticism, founding mythologies, legends, and religious syncretism.

Matt Piercy

Mt. San Jacinto College

Mentor: Erik Ozolins

Demystifying the Denisovans: Initial Body Mass Estimates of an Archaic Hominin Group

The Denisovan genome has been sequenced but little is known about their morphology. Allometric scaling of tooth sizes yields initial estimates of Denisovan body mass.

Alexandria Gonzalez

Saddleback College

Mentor: Bill Billingsley

Human Dissections: Anatomical Discovery in the Italian Renaissance

My research focuses on the transformative development of anatomy with Vesalius' work, analyzing his studies and its relevance during the Renaissance and our modern world.

Session 2: Oral Presentations

10:30-11:45 am

SSC MPR 2

Giorgio Buono

Long Beach City College
Mentor: Nate Hertweck

Marijuana Legalization Is a Social Justice Issue

Grassroots cannabis advocates fought for equity of participation in industry; however, national legalization may perpetuate exclusion of minorities.

Orlando Laws

Santiago Canyon College
Mentor: Tiffany Gause

Hallucinating the Harm: Making the Case for the Legalization of Psychedelics

Psychedelic substances are often surrounded by negative perceptions. While stigmatized as addictive substances, the legalization of psychedelics could benefit society significantly via therapeutic applications.

James Vargas

San Bernardino Valley College
Mentor: Edward Gomez

Native American Drug and Alcohol Abuse has a Direct Connection to an Increase in Off Reservation Sales

Native American alcoholism and drug abuse can be directly correlated to the off reservation influx of sales in alcohol and drugs.

Isaac Alpert

El Camino College
Mentors: Rachel Williams and Kassia Wosick

The Bipartisan Campaign Reform Act: The Especially Interesting Trick of Severability

An analysis of special interests using the judiciary to strike down various statutes within the Bipartisan Campaign Reform Act of 2002.

Session 2: Oral Presentations

10:30-11:45 am

SSC MPR 3

Joel Lexiss Tenepere
Long Beach City College
Mentor: Jeff Wheeler

Resolving The Paradox: The Puzzle of Anomalous Value Stock Returns Despite Efficient Markets

Anomalous returns of value stocks are driven by persistent behavioral biases and increased exposure to risks rather than a violation of the Efficient Market Hypothesis.

Serena Zhu
El Camino College
Mentor: Mitchell Middler

Automate Stock Trading Using Machine Learning

Can AI predict the stock market? Yes, it is now possible to train machine learning agents to develop and execute profitable trading strategies.

Nicole Karraa
Saddleback College
Mentor: Anwar Hijaz

Economic Structures and the Rapid Transformation of Post-Modern Society: How to Implement Reforms and Address Social and Economic Inequality

Explores post-modern economic structures, focusing on implementing reforms to address inequality, promote sustainability, and create equitable growth in rapidly transforming societies.

Session 2: Oral Presentations

10:30-11:45 am

SSC 216

<p>Annie Do Cypress College Mentor: Kathryn Sonne</p>	<p>COVID, Care Work, and Colonialism: The Devaluation of Care Work and Exploitation of Migrant Filipina Nurses The uneven division of care work concentrated among Filipina nurses during the COVID-19 pandemic necessitates closer examination of the profession's colonial roots in the Philippines.</p>
<p>Ishmeet Dhillon Las Positas College Mentor: Felipe Ponce</p>	<p>Roots of Resilience: How Punjabi/Sikh Immigrants Developed Identity in America A look into the experiences of the Punjabi Sikh population in the United States through Ethnic Studies methodologies.</p>
<p>Lori Shrikian Irvine Valley College Mentor: Joon Kil</p>	<p>Unconventional Allies: Assessing Why the United States of America Gave Military Assistance to the Rebels in the Syrian Civil War from 2012 to the Present Many reasons led to the United States deciding to give military assistance to the rebels in the Syrian Civil War beginning in 2012.</p>
<p>Alex Gonzalez Long Beach City College Mentors: Jeff Wheeler and Matthew Atkinson</p>	<p>What Is Life in the "Wild Wild West" Really Like?: An Analysis of a Village in Mexico—The Impact of Tourism and State Policies on Rural Mexican Governance Tourism's economic benefits in rural Mexican municipalities come at the cost of disrupting local traditions and governance, highlighting tensions between cultural preservation and state-driven modernization.</p>

Session 2: Oral Presentations

10:30-11:45 am

SSC 235

Arsham Mehrshahi
LA Pierce College
Mentor: Erin Hayes

How Culture Affects Communication in the Workplace

As the world becomes more globalized, diversity creates more room for problems, specifically, miscommunication. This leads to inefficiency and perhaps, disaster.

Rayanne Fadich
El Camino College
Mentor: Mora Mattern

The Psychology of Connection: How Quality Communication Helps Combat Loneliness

As the U.S. faces a "loneliness epidemic," I strive to explore strategies to enhance social connections through empathy, active listening, and turn-taking in conversations.

Markus Leonardo
Glendale College
Mentor: Michael Harnett

Speaking Stigma: An AI-Based Approach for Detecting Adolescents' Mental Illness Prejudice Through Conversation

The development of a language-based AI that analyzes adolescents' responses and scores their mental illness prejudice along the Prejudice towards People with Mental Illness scale.

Patrick Reese
Los Angeles City College
Mentor: Sarah Crachiolo-Garcia

Autism and Interpersonal Communication: Common Issues and an Intervention Strategy

A presentation on some common challenges that autism brings to interpersonal communication, and a helpful intervention to improve some aspects of communication for autistic individuals.

Session 2: Oral Presentations

10:30-11:45 am

SSC 308

Julia Cuevas

Crafton Hills College
Mentor: T.L. Brink

The Political Divide in America: Demographic Profiles

This project aimed to examine the factors contributing to the political divide by investigating demographic profiles and voters' perceptions of candidates as unifying or divisive.

Curtis Ahn

Pasadena City College
Mentor: Shane Underwood

From Grassroots to Algorithms: The Rhetoric of Facebook Campaigning in the 2008 Election

This paper analyzes the Obama campaign's use of Facebook in 2008, highlighting grassroots empowerment, inclusiveness, and innovation, while critiquing polarization, privacy concerns, and digital dependency.

Darya Derakhshani

Amanda Cercado
Pasadena City College
Mentor: David Uranga

Compromising the American Identity: The Modern Day Civic Engagement Crisis in an Ever-Changing Sociopolitical Climate

The U.S.' tumultuous sociopolitics suggest that civic engagement is fundamental in preserving American democracy.

Jawad Khadra**Kai Sims**

Irvine Valley College
Mentor: Emily Liu

Boycotts: They Work (If Done Right)

Exploring boycotts as effective protests, this study analyzes key factors driving success, including motivations, socio-political dynamics, and strategies, offering insights for activists and policymakers.

Session 2: Oral Presentations

10:30-11:45 am

SSC 316

Aaliyah Medawar
San Bernardino Valley
College
Mentor: Mandi Batalo

Media Literacy: The Preservation of a Dying Art
Anti-intellectualism in media allows those in power to control others through ignorance, therefore it is vital for humanity's survival that media literacy is preserved.

Danya Auda
Leticia Martell
Riverside City College
Mentors: Citlalli Anahuac
and Daniel Topete

Our Bodies Our Justice
A "zine" discussing injustice related to the Medical and Prison Industrial- Complexes. Various malpractices related to gynecology are discussed, and disparities within the prison system.

Pearl Hsieh
Pasadena City College
Mentor: Shane Underwood

Pop and Politics: Female Popstars' Rhetoric of Reproductive Healthcare in the Post-Roe Era
This paper examines female popstars' rhetoric on reproductive healthcare after Roe v. Wade and its implications for public discourse, activism, and access to reproductive services.

Ryka Rohith
Irvine Valley College
Mentor: Shellie Ochi

Abortion Laws and State Intervention: Will State and Court Changes Reduce Legal Abortions?
This paper examines the impact of the June 2022 U.S. Supreme Court decision overturning Roe v. Wade and state-level legislative changes on abortion services.

Session 2: Oral Presentations

10:30-11:45 am

SSC 329

Stefanie Siau

Irvine Valley College
Mentors: Carrie Goulding
and Adam de Petris

Addressing Homelessness in Higher Education: Consequent Effects to Food and Housing Insecurity

With a struggle to afford basic needs due to inflation in the housing market, various governmental policies guide the college population towards a healthier future.

**Brandon Woo
Jingdu (Jason) Cao
Jesus Larios**

Yuxuan (Flora) Li
East Los Angeles College
Mentor: Ruth Blandon

Strength in Unity: Students Tackling Homelessness and the Basic Needs of their Fellow Community College Students

Community College students take action and address the growing issue of hunger and homelessness among fellow Community College students to foster academic success and achievement.

Nallive Espadas

Pasadena City College
Mentor: Desiree Zuniga

The Role of 'Servingness' at Hispanic-Serving Institutions in Advancing Latine/x Excellence through Paid Leadership Positions: Student Advisory EQUIPO at Pasadena City College

Servingness at HSIs prioritizes Latine/x students' success. At Pasadena City College, EQUIPO exemplifies this through paid leadership, uplifting student voice, and holistic student support.

**Jasmine Bonilla
Kayla Gevorkian
Lucy Galamdaryan
Sofia Yosucio
Jaydn Kim**

Pasadena City College
Mentor: Liesel Reinhart

Non-Academic Social Integration in Post-Secondary Education: Differences Between Two and Four-Year Institutions

Social integration plays a pivotal role in shaping students' educational experiences, yet its dynamics differ significantly between community colleges and four-year institutions, influencing students' success.

Session 2: Oral Presentations

10:30-11:45 am

SSC 335

Kylie Kirkland

Victor Valley College
Mentor: Tim Adell

Plato's Dialogues: The Question of Virtue

Plato's Five Dialogues lays the foundation for a Western discussion of virtue, connecting it to the core of basic thought and human goodness.

Warren Neil

West Los Angeles College
Mentor: Stella Setka

Poe's Mask of Morality: Perverseness Rationalizes Southern Slavery

Edgar Allan Poe's use of the "spirit of perverseness" in his works rationalizes the pro-slavery ideology against the rising abolitionist movement of his era.

Jeanine Torres

West Los Angeles College
Mentor: Stella Setka

The Mind Behind the Pen: American Modernist Writers and the Literary Expression of Trauma

This essay explores how American Modernists like Langston Hughes, F. Scott Fitzgerald, and T.S. Eliot use literary expression to confront trauma and repressed emotions.

Katheryn Ortega

Long Beach City College
Mentor: Laura Scavuzzo
Wheeler

Lembas: Exploring Narratives, Christ, and the Psychological Substrate of Ideas through the Food of The Lord of the Rings

Revealing the psychological architecture of ideas in literature, Christianity, and more through the lens of food in The Lord of the Rings.

Session 3: Oral Presentations

12:45-2:00 pm

HUB 260

Aylan Rosales

West Los Angeles College
Mentor: Katherine
LaTourrette

Much Ado about Nothing: A Feminist Paradox

My essay argues that Shakespeare's play not only critiques sexism but also contributes to shaping a progressive representation of women in a restrictive era.

Madeline Helton

Mt. San Jacinto College
Mentor: Michelle Stewart

Transracial Adoptions: Memoir Importance and the Elimination of a Single Story

The intersectionality of race and adoption status is revealed through the analysis of Korean and African American adoptee memoirs, deconstructing a single story of adoption.

Lolita Mojica

Long Beach City College
Mentor: Nate Hertweck

Afrofuturism and the Audacity of Black Joy

Exploring Afrofuturism as the root of Black joy, this research shows how speculative narratives transcend imagination to critique oppression and envision empowering Black futures.

Session 3: Oral Presentations

12:45-2:00 pm

HUB 265

Elissa Ferguson

Mt. San Jacinto College
Mentor: Christina
Yamanaka-Vu

How the Transatlantic Slave Trade Shaped the African American Funeral

The transatlantic slave trade significantly influenced African American funeral customs, shaping their culture and traditions by forcibly bringing millions of Africans to the Americas.

Isabella Resendiz

Mt. San Jacinto College
Mentor: Vanesse Hiten

The Importance of Passing down and Conserving Ecological Knowledge and the Natural World as Seen in its Crucial role in the Underground Railroad

The Underground Railroad is one of the most successful resistances in U.S history, largely thanks to the usage and knowledge of the Natural Environment.

Jonathan Laffey

Los Angeles City College
Mentor: Christina Heisser

Black Lives Matter, Impossible Goals in the Era of Peace: How the IRA Achieved the Goal of BLM in the Era of Violence

Exploring parallels between the BLM movement and the Irish Republican Army, highlighting how violence enabled the IRA to achieve goals BLM struggles to realize peacefully.

Jonny Vasquez

Santa Ana College
Mentors: Stephanie Keefer
and Moises Medina

Patterns of Subjugation

This paper examines the gray area that exists between Church and State in the U.S., a gray area that creates problematic legislation.

Session 3: Oral Presentations

12:45-2:00 pm

HUB 268

<p>Sidhant Parashar Las Positas College Mentor: Howard Blumenfeld</p>	<p>Decoding Bitcoin Trends: Using Mathematics to Create Custom Cryptocurrency Market Indicators For Trading Applying custom calculus-based derivations of price, volume, and other market factors, to provide valuable insights for making profitable trades in Bitcoin markets.</p>
<p>Rohan Bambhania Ethan Nguyen Chris Rodas Irvine Valley College Mentor: Michael Salviani</p>	<p>An Immersive Gaming Experience: Comparing AI Algorithms to Assist Game Development Comparing two AI algorithms based on their possible applications in assisting game development to reduce artificially inflated video game budgets and development cycles.</p>
<p>Rylen Sabhlok MiraCosta College Mentor: Aviral Shrivastava</p>	<p>A Large Vision Language Model Algorithm for Autonomous Vehicle Social Scenarios A large vision language model for out of distribution and social scenarios in autonomous vehicles using visual question answering and policy adaptation.</p>
<p>Jaewon Yi Irvine Valley College Mentor: Michael Salviani</p>	<p>ScreenMania on Wheels: The Spread of Driver Distraction Caused by the Disappearance of Physical Switches in Vehicles With the increased dependence on digital systems for essential vehicle functions, drivers lose perceptual awareness due to complicated media systems.</p>

Session 3: Oral Presentations

12:45-2:00 pm

HUB 269

<p>Ivy Auyeung Los Angeles City College Mentor: David Sedghi</p>	<p>United We Stand, Divided We Sit: Social Identity Influences Classroom Seating Choice Leading to Self-Segregation The combination of homophily and territoriality induces classroom seating choice that encourages self-segregation by social identity impacting psychosocial development of students.</p>
<p>Alexis Yrigoyen Chaffey College Mentor: Allison Tripp</p>	<p>From Shelf to Self: How Collectibles Contribute to Nerd Identity This study uses surveys, interviews, and observations to understand how nerd culture memorabilia contributes to self-expression and social connection.</p>
<p>Maria Infante Arboleda Pasadena City College Mentor: Shane Underwood</p>	<p>Modern Doll Brands Approach on Educational Values and Their Effect on Children's Development Current focus on educational values within fashion doll branding enhances children's development via the dolls' particular strengths as pedagogical tools.</p>
<p>Henoch Perez Citrus College Mentor: Erin Tate</p>	<p>The Tortured Artist: Exploring the Elusive Connection Between Mental Illness and Creativity An exploration of the associations between mental illness and creativity. Examining what kind of mental illnesses have the greatest impact on creativity.</p>

Session 3: Oral Presentations

12:45-2:00 pm

HUB 355

Nicole Toshima

Irvine Valley College
Mentor: Kristen Skjonsby

Concern for Dystopian Realization: The Antithetical Intersection of AI, Employment, and Diversity in Cinema

A study of the film industry's treatment of marginalized communities versus white narratives, and its subsequent contributions to AI's growing presence in the filmmaking space.

Muslima Mirkhalilova

Los Angeles City College
Mentor: Can Aksoy

It's a Double-Edged Sword: The Conformist and Subversive Nature of Female Humor in The Marvelous Mrs. Maisel

Examining the duality of female humor as it shifts from reinforcing gender norms to radically empowering women in the series The Marvelous Mrs. Maisel.

Charlotte Crewse

MiraCosta College
Mentor: Daniel Ante-Contreras

The Satire of Political Media: A Semiotic Analysis of Veep

Through a semiotic analysis of Veep, I argue that its comedy desensitizes viewers to political issues, shifting political engagement from action to entertainment.

Blessing Beyang

Mt. San Jacinto College
Mentor: Erik Ozolins

Some Things About Love

This research highlights that Steven Universe and The Owl House exemplify passive inclusivity, teaching self-love and acceptance through authentic LGBTQ+ characters that resonate with viewers.

Session 3: Oral Presentations

12:45-2:00 pm

HUB 367

Ariana Fernandez

Mt. San Antonio College
Mentor: Misty Kolchakian

The Hidden Cost of Comparison: Unpacking the Psychological Impact of Upward Social Comparison on Self-Worth

A survey of community college students demonstrates that upward social comparison is significantly associated with envy, cognitive distortions, and lower self-esteem.

Joseph Baky

Chaffey College
Mentor: Hannah Lucas

The Student Becomes the Master: Examining the Correlation Between Student-Professor Interaction and Self Efficacy

A correlative study was performed to examine the relationship between student-professor interaction and self-efficacy. Data was collected in institutions from the USA and Egypt.

Gabriel Graves

Riverside City College
Mentor: Ricardo Crespo

The Impact of Political Ideology on Racial Perceptions and Mental Health Status Among Community College Students: A Normative Approach

A normative study that demonstrates the need for more intersectional research among community college students and a methodological model for its implementation.

Galia Diaz-Montoya

Irvine Valley College
Mentor: Brandee Idleman

Not Your Crip: Addressing Structural Ableism in Media Types, Accessibility, and Uplifting Disabled Student Voices

Through a cross-sectional survey, the perception of disability portrayal in campus and online media types will be analyzed in disabled and non-disabled identifying student populations.

Session 3: Oral Presentations

12:45-2:00 pm

SSC GM 1

Daniel L. Benier

Los Angeles City College
Mentor: Evan Kendall

The Reality of Numbers

For centuries, people have debated if numbers are human invention or if they always existed. Now we can find the answer using a quantum computer.

Jorge Aleman

Los Angeles Harbor College
Mentor: Joachin Arias

Statistical Errors

This presentation identifies and addresses key statistical errors, such as sampling and non-sampling errors, their effects on scientific validity, and strategies to prevent them.

Rohit Kancharla

Las Positas College
Mentor: Elena Cole

Dissecting the Stappy Life: A Mathematical Framework for Understanding the Human Experiences behind a Happy Life

Quantifies philosophical, psychological, and sociological insights through mathematical modeling and statistical analysis of an 11-question survey to identify what constitutes a happy life.

Session 3: Oral Presentations

12:45-2:00 pm

SSC GM 3

Alicia Chloe Nicole Geronimo

Mt. San Jacinto College
Mentor: John Torres

“Mga alingawngaw ng pag-uwi ng banga” - Echoes of the Pot’s Homecoming

Exploring Ivan Seal’s focus on memory’s “glitches,” this painting reinterprets the 'Banga' dance as a fragmented and restructured recollection, blending cultural tradition with surreal abstraction.

Kathy Htwe

El Camino College
Mentor: Karen Whitney

Art as Resistance: Burmese Creators Defy Oppression

Myanmar’s eight-decade fight for democracy continues amid conflict. This project examines how exiled artists express the intricacies of displacement, identity, and civil war violence.

Daniela Solano

Los Angeles City College
Mentor: Soraira Urquiza

Natalie Godinez: A Talk With An Artivista

A Chicana arts educator from the U.S.-Mexico borderlands shares her inspirations and collaborative art-making approach to social justice for immigrant communities.

Nadine Cobosh

East Los Angeles College
Mentor: Surana Singh

Contemporary artists who use Installation to Explore Chinese Identity

Xu Bing and Cai Guo Qiang grew up during the rise of Mao Zedong in China and express their experiences in their contemporary art practices.

Session 3: Oral Presentations

12:45-2:00 pm

SSC MPR 1

Narcissa Thomas

Citrus College
Mentor: Jennifer Miller-
Thayer

Maritime Folkloric Practices as Religious Syncretism during the Golden Age of Piracy

An argument for considering the enculturation of sailors aboard new vessels as religious syncretism rather than simply cultural syncretism as current literature suggests.

Domenic Puccio

Saddleback College
Mentor: Jessica Budica

Bewitching Nature, Isolating World: The Appeal of Pagan Ideas in a Denaturalized World

A paper demonstrating possible reasons for people to convert to paganism in the modern world, through the lens of a desire for connection to nature.

Alex Rodriguez

Saddleback College
Mentor: Suki Fisher

A Strenuous Game of Tug-Of-War: Societal Confusion from Religion & the Modern World

Research exploring the role of religion in a progressing world that results in a confused society: morality and scientific progression.

Alys Dickerson

Citrus College
Mentor: Jennifer Miller-
Thayer

Politics and the Pulpit: The Politicization of Christian Worship in a Polarized Society

This project will explore the cause-and-effect relationship that the politicization of evangelical worship has with societal polarization through an intersectional and anthropological lens.

Session 3: Oral Presentations

12:45-2:00 pm

SSC MPR 2

<p>Kimberly Camarillo Gabriel Carrera Rosas Jonathan-David Oeur Long Beach City College Mentor: Kyle Muldrow</p>	<p>More Than Just Attending: Uncovering the Barriers Blocking Student Engagement Student engagement goes beyond attendance—science and surveys uncover barriers, revealing insights that drive participation, connection, and a stronger sense of belonging.</p>
<p>Nicolas Salgado Pasadena City College Mentor: Shane Underwood</p>	<p>Understanding Audiences: Fostering Individual Language Learning for K-12 Students in the Los Angeles Unified School District The ELPAC is a quantitative approach to teaching English in which students are not taught how to engage with language.</p>
<p>Christian Reeves Moreno Valley College Mentor: Jennifer Floerke</p>	<p>Speaking the Language of Success: How Communication Competence Drives STEM Student Achievement With communication skills overlooked for content in STEM fields, a positive relationship is explored between academic success and communication skills, with possible solutions to implement.</p>
<p>Cade Hamilton Long Beach City College Mentor: Jeff Wheeler</p>	<p>Show, Don't Tell: The Implementation of Film Literacy Classes in Secondary Education This essay argues that the application of film literacy courses into secondary education will be a contemporary evolution of liberal arts courses in high schools.</p>

Session 3: Oral Presentations

12:45-2:00 pm

SSC MPR 3

<p>Corah Miller Chaffey College Mentor: Bradley Hughes</p>	<p>In the Beginning: Analyzing Evidence and Theories Behind Cosmic Origins The early universe's formation, as described by the Big Bang theory, is supported by evidence like the Cosmic Microwave Background, nucleosynthesis, and large-scale structure formation.</p>
<p>Noah Burley Mt. San Jacinto College Mentors: Christina Yamanaka-Vu and Michael Plotkin</p>	<p>When Fusion Will Power Humanity Investigating the viability and timeliness of nuclear fusion through an original interview with a fusion researcher and analysis of public perception survey data.</p>
<p>Lezly Albro Cerro Coso Community College Mentor: Scott Cameron</p>	<p>Physics and Phytoplankton Satellite remote sensing is a vital tool in assessing phytoplankton populations, and therefore offers a unique glimpse into the health of the biosphere.</p>
<p>Jaxon Tabesh Mt. San Jacinto College Mentor: Christina Yamanaka-Vu</p>	<p>The 2022 Nobel Laureates and the Future of Quantum Computing and Cybersecurity The 2022 Nobel Prize laureates — through their experimental validations — provided evidence for many important principles that have enabled the burgeoning of its subfields for important practical applications.</p>

Session 3: Oral Presentations

12:45-2:00 pm

SSC 216

<p>Frida Garcia Citrus College Mentor: Jennifer Miller-Thayer</p>	<p>Revitalizing Rural Japan: Addressing Elderly Isolation through Cultural Solutions Analyzing the impact of rural depopulation on elderly health in Japan and proposing culturally relative solutions inspired by Okinawa's Moai tradition.</p>
<p>Ashley Lau Pasadena City College Mentor: Shane Underwood</p>	<p>How to Mitigate the Effects of Ageism: A Hermeneutical Approach on Aging in the Modern Day A hermeneutical approach to the process of aging counteracts the effects of ageism present in society that time-constrained age-prevention methods fail to remedy.</p>
<p>Alessandra Zagaceta Los Angeles Harbor College Mentor: Josie Rojas</p>	<p>Geospatial Analysis of Food Environments for Adults 60 years or older: Exploring the Impact of Supermarket Proximity on Diabetes Mellitus in South Los Angeles (SLA) Can limited access to healthy food increase a region's diabetes prevalence? Examining demographics and SNAP food vendors in South-LA can demystify diabetes trends within communities.</p>
<p>Angela Ramos Pasadena City College Mentor: Shane Underwood</p>	<p>Corporate or Care: A Focus on the Mental Health Resources in Foster Care An analysis on the inefficiency of the economic structures assessing foster care children's mental health, suggesting a human science approach to potentially personalize health care.</p>

Session 3: Oral Presentations

12:45-2:00 pm

SSC 235

Anne Merie Nguyen
Cypress College
Mentor: Kathryn Sonne

Designed to Connect: How Video Games Shape Hearts and Minds

Video games foster empathy and connection through immersive storytelling, moral decision-making, and character-driven dynamics, offering unique tools for ethical reflection and societal impact.

Yousuf Khan
Norco College
Mentor: Cameron Young

The Attraction Towards Game Design

Principles of game design such as narrative, challenges, rewards, and environmental interactions can serve as factors that motivate players' engagement between themselves and their gameplay.

Ramzi Steenhoek
Long Beach City College
Mentor: Jeff Wheeler

A Digital Goldmine: What Video Games Say About Us

Analysis on the impact and nuances video games have on culture and society, utilizing the key example of Minecraft's Cake.

Nick Vatanshenas
Kiana Aryana
Irvine Valley College
Mentor: Patricia Beckmann

Power and Emotion: Effects of Power on Players' Emotions in Video Games

This study explores how power affects player emotion in video games and further explores how power dynamics, both obvious and subtle, affect player experience.

Session 3: Oral Presentations

12:45-2:00 pm

SSC 308

Joseph Jung

Cypress College

Mentor: Andrea Cullinen

Analyzing Education Level, Income, and 2023-2025 Occupational Stability using Data Science: Linear Regression and KNN Classification Algorithm

Analyzing the relations between occupations' entry-level education and employee wage versus their stability and employment projections for 2025 using California's Employment Development Department's government data.

Maxime Chung

El Camino College

Mentor: Benjamin Mitchell

Exploring the Relationship Between 4-year Institutions' Selectivity Tiers and Net Price Stability Across Income Brackets

This study examines whether institutional selectivity tiers correlate with year-over-year net price stability across income brackets, focusing on resilience to economic fluctuations.

Jingdu (Jason) Cao

East Los Angeles College

Mentor: Allen Coson

Development of U.S. and China's Economic Engines: California, Guangdong, and Their Global Prospects

Using a case study, and key economic and political variables, I analyze multi-lateral institutions' crucial significance for economies.

Helen Samuel Wan**Isaac Gutierrez****Aisha Bilgrammi**

Irvine Valley College

Mentor: Adam Ghuloum

The Correlation Between Gross Domestic Product (GDP) and the Prevalence of Malaria, HIV, and Tuberculosis in Countries According to Gross National Income (GNI) Classification

A statistical study examining the correlation between GDP per capita and the prevalence of malaria, HIV, and tuberculosis from sixteen countries classified according to GNI.

Session 3: Oral Presentations

12:45-2:00 pm

SSC 316

<p>Laureen Nicole Mesina Los Angeles Harbor College Mentor: Joachin Arias</p>	<p>Cardiac Regeneration The mmp14b enhancer drives heart regeneration in zebrafish by activating repair genes. Its absence in mammals limits healing, but unlocking it could revolutionize heart treatments.</p>
<p>Cher Swan Scarlett Orange Coast College Mentor: Tanya Hoerer</p>	<p>Water into Doom: Balancing AI with Climate Action & Environmental Costs at the Water-Energy Nexus This research critically examines the hidden scaling costs of Artificial Intelligence (AI) at the water-energy nexus and identifies its critical utility in climate change mitigation.</p>
<p>Amy Xie Irvine Valley College Mentor: Carrie Goulding</p>	<p>Small-Scale Supplements: Responsible Desalination in SoCal My research analyzes desalination in Southern California using the Doheny and Huntington Beach proposals as case studies to identify strategies for implementing responsible desalination practices.</p>
<p>Hania Kashif Norco College Mentors: Monica Gutierrez and Jacob Drainville</p>	<p>Beyond Sunlight: Poly-metallic Nodules and the Mystery of Dark Oxygen Exploring how poly-metallic nodules on the ocean floor contribute to oxygen production through electrochemical processes, revealing new pathways in Earth's oxygen cycle and extraterrestrial possibilities.</p>

Session 3: Oral Presentations

12:45-2:00 pm

SSC 329

Sydney Iravanchy
El Camino College
Melissa Fujiwara

Balancing Hate Speech Regulation and Free Speech on Digital Platforms: A Socio-Legal Perspective

Presentation explores legal and sociological aspects of regulating hate speech while protecting free speech, analyzing its impact on society, and proposing policies to mitigate harm.

Zayd Qazi
Norco College
Mentors: Melissa Wilson and
Cameron Young

Stress, Mindfulness, and Social Media Motivations

Uncovering the impact of social media by analyzing the factors of mindfulness, stress, and social media motivations: social interaction and information seeking

Yoon Thiri
Pasadena City College
Mentor: Shane Underwood

Disconnecting for Connection: A Hermeneutical Way of Digital Detoxing for Social Media Addiction and Social Isolation

Digital detoxing overlooks the deeper psychological ties between problematic social media usage and loneliness, which can be addressed more effectively by implementing philosophical hermeneutics.

Cristobal Duran
Long Beach City College
Mentor: Christina
Moorhead

XOXO Gossip Girl: An Understanding of Gossip and its Role in Society

Gossiping can be seen as unethical activity. The study aims to understand how the media has portrayed a negative side of gossip despite its benefits.

Session 3: Oral Presentations

12:45-2:00 pm

SSC 335

Shaista Sharief
Taylor St. Clair
Sumaiyah Ali

Irvine Valley College
Mentor: Patricia Bellas

The Price of Scrolling: How Increased Social Media Use Harms Well-Being and Fuels Envy

Analyzing the relationship between social media engagement and user well-being and envy: Implementing healthier online use through cognitive behavioral therapy.

Alexander Manayan

Mt. San Antonio College
Mentors: Lori Walker and
Carol Impara

Stuck in the Scroll: Limits on Social Media Algorithms

The federal government should place limits on addictive social media algorithms due to their profit-driven user manipulation, negative mental health effects, and harmful economic impact.

Isabella Migliozi

Pasadena City College
Mentor: Edward Feser

Violence on Social Media and Compassion Viewed Through the Eyes of Philosophers

The writings of various philosophers, such as Aristotle, Aquinas, and Hume, provide us with a new perspective on violence seen on social media and compassion.

Yilin Liu
Luoqi Wang

Irvine Valley College
Mentor: Roy Zipstein

From TikTok to Stocks: How Gen-Z's Investment Choices Are Shaped by Social Media

Gen-Z students increasingly rely on social media for investment advice, but mixed trust and biased content highlight the need for improved financial literacy.

Session 4: Oral Presentations

2:15-3:30 pm

HUB 260

Julissa Gonzales
Chaffey College
Mentor: Allison Tripp

The Evolution of the Arabic Language

This project explores how Arabic culture and language have influenced Spanish culture and language since the fall of the Moorish empire.

Josh Weiner
Los Angeles City College
Mentor: Soraira Urquiza

Felix Longoria and the Dilemma of Assimilation in Mexican American History

How racial discrimination against a deceased World War II veteran demonstrated the limits of the early 20th century moderate, assimilative Mexican American civil rights movement.

Yareni Pelayo Sanchez
San Bernardino Valley College
Mentor: Edward Gomez

What Can't Women Do? Influential & Empowered Chicana Women of California

A personal dive into four inspirational women who made a difference in California history.

Maham Khan
Rameen Naz
Rahma Munir
Norco College
Mentor: Michael Bobo

Heera Mandi: The Guardians of Culture and Freedom

A historical research of Heera Mandi in Lahore, highlighting its cultural importance, artistic legacy, and the power of its women, while addressing modern media portrayal.

Session 4: Oral Presentations

2:15-3:30 pm

HUB 265

Carter Schlechter

Irvine Valley College

Mentor: Jeffrey Johnson

Comparative Analysis of Donor-Derived Cell-Free DNA (dd-cfDNA) Products in Organ Transplantation

This work will analyze and compare major donor-derived cell-free DNA products—CareDx AlloSure, Eurofins OmniGraf, and Natera Prospera—evaluating market trends, product differentiation, and clinical implications.

Hannah Rosario**Fady Hanna**

Mt. San Jacinto College

Mentor: Nick Reeves

CRISPR Resistant lacZ Mutants Discovered in E. coli

Following a CRISPR-Cas9 experiment on Escherichia coli, 11 blue unedited colonies were discovered and confirmed to have mutations that prevent CRISPR editing of lacZ.

Ryan Wilson**Yovany Gaspar**

El Camino College

Mentor: Karla Villatoro

Spice Wars: Exploring Allelopathic Effects of Spices on Dandelion Growth

This experiment examines the use of spices as naturally occurring and sustainable herbicide alternatives by testing their ability to inhibit Dandelion growth.

Riana Motewelli

Irvine Valley College

Mentor: Danilo Caputo

Climate Change Effects on Fish

My research project examines the significant impacts of climate change on fish populations, exploring the underlying causes, associated challenges, and potential solutions.

Session 4: Oral Presentations

2:15-3:30 pm

HUB 268

Grace Aranda

Mt. San Antonio College
Mentor: Diana Churchill

Hypertonic Solutions make Pimple Patches More Effective

This experiment explores tonicity and how it may affect acne treatment using hydrocolloid patches. Hypertonic solutions were found to be significantly most effective.

Aidan Isaac Lalezari

LA Pierce College
Mentor: Alia Latif

Mistletoe: A Possible Standalone Homeopathic Cure for Colorectal Cancer?

While chemotherapy has been proven to treat colorectal cancer, homeopathic remedies like mistletoe are examined to assess potency, side effects, prognosis, and role in treatment.

Emily Oh**Ann Afonso**

Irvine Valley College
Mentor: Emily Liu

That Time of the Month or Death: The Pitfalls of Current Detection and Diagnostic Methods for Ovarian Cancer in Middle-aged to Elderly Asian Women

To identify the barriers contributing to delayed and inaccurate diagnoses leading to low prognosis and high mortality rates of ovarian cancer in Asian-American women.

Valeria Carvajal

Los Angeles Harbor College
Mentor: Joachin Arias

Transforming Pediatric Chemotherapy: Towards Safer Treatments and Brighter Futures

As a childhood cancer survivor, I advocate for increased research and funding to advance innovative treatments like nanotechnology, offering hope for safer, more effective care.

Session 4: Oral Presentations

2:15-3:30 pm

HUB 269

<p>Kalia Barton Sarah Harati El Camino College Mentor: Stephanie Burnham</p>	<p>Medicine's Missing Parts: Examining Gender-Specific Gaps in Medical Research, Reproductive Health, and Treatment Exploring the harsh reality and all-encompassing impact of gender bias in medicine, including male-centered research, inequitable reproductive care, and the dismissal of women's pain.</p>
<p>Said Hernandez Mt. San Jacinto College Mentors: Erik Ozolins and Kathleen Conner</p>	<p>The Other Side of the Equation: Healthcare Providers' Barriers to Providing Gender-Affirming Care Systemic and provider-side barriers to gender-affirming care for young transgender patients, and possible solutions to address them, are explored through interviews with healthcare providers.</p>
<p>Euis Muljono Ariana King Kara Terray Irvine Valley College Mentor: Kristen Skjsjonsby</p>	<p>The Violence against Vaginas: The Enduring Impact of Racial and Gender Violence in Women's Health Patriarchal and racial violence plagues women's healthcare, perpetuating a systemic hierarchy that taints the comfort and equity necessary for modern care.</p>
<p>Ruby Bartlett Citrus College Mentor: Jennifer Miller-Thayer</p>	<p>Gender Bias and Injustice in Women's Cardiovascular Health Women's cardiovascular health is under researched, and often disregarded by medical professionals, resulting in disempowerment of female patients and health issues being left unaddressed.</p>

Session 4: Oral Presentations

2:15-3:30 pm

HUB 355

Ramona Rivas
Aileen Soto
Kirsty Cheung
Madison Sherrit
Michelle Chan

Pasadena City College
Mentor: Shane Underwood

Choreographed Sisterhood: Sorority Recruitment at the University of Alabama

This paper examines the rhetoric used by sororities at the University of Alabama to display commitments to community, philanthropy, and self-improvement while recruiting new members.

Clairose Matias

Long Beach City College
Mentor: Jeff Wheeler

Racing Towards Equality: Feminism in the Fast Lane

Formula 1's tracks are engraved with history of accomplished drivers. In an evolving world, women are making their mark in the highest class of motorsports.

Trevor Wong

Santiago Canyon College
Mentor: Tiffany Gause

Bridging the Divide: The Case for the Sepulveda Line

The Sepulveda Line addresses LA's transit challenges. The heavy rail option is closely aligned with the Line's project goals and is therefore the superior option.

Haley Thompson

Long Beach City College
Mentor: Jeff Wheeler

The Dominator 3: Human Conquest of Nature in Tornado Alley

Meteorologist Reed Timmer's tornado intercept vehicle made to withstand and survey tornadoes, the Dominator 3, challenges the dynamic between man and nature in Tornado Alley.

Session 4: Oral Presentations

2:15-3:30 pm

HUB 367

Aiza Khalil

Irvine Valley College
Mentor: Danilo Caputo

A Garbage Solution: Energy Efficient Vehicles Affect Climate Change

A review of the life cycle of electric vehicle batteries with an analysis of the recycling methods and suggestions to make the life cycle environmentally safer.

Emilia A. Ramirez

Citrus College
Mentors: Jennifer Miller-Thayer and Nicole Ary

Abandoning Electricity as a Source of Energy

Although electricity has become integral to human life, we must reconsider if the effects of nEMFs on humans and the environment are worth the risk.

Mark Bowe

Cerro Coso Community College
Mentors: Claudia Sellers and Guck Ooi

Biofabrication: You Are What You Wear

The textile industry causes significant environmental harm, but these issues can be addressed through revolutionizing our entire industry by bio-engineering textiles.

Maya Kalle

Saddleback College
Mentor: Morgan Barrows

Distribution of Lead in Soil between North and South Orange County: Correlations to Racial, Economic, and Historical Demographics

Expansion of studies on environmental racism in Orange County, focusing on soil lead contamination and the historical and social factors contributing to current environmental health.

Session 4: Oral Presentations

2:15-3:30 pm

SSC GM 3

Robert Holm
Khang Vuong

El Camino College
Mentor: Teresa Palos

Effect of Diet on the Production of Butyrate by Enteric Bacteria

In our study, we examined how different diets affected the gut bacteria's production of short chain fatty acids, molecules that have wide reaching health impacts.

Samuel King

Cerro Coso Community College
Mentors: Claudia Sellers and Guck Ooi

A Possible Plastic-Posed Threat for our Plastic Generations

This research examines the state of plastic production and investigates the presence of microplastics in human placenta, along with their potential negative effects.

Christian Lamattery

Mt. San Jacinto College
Mentor: Michael Plotkin

Taking a Familiar Lab to New Heights: Benedict's Quantitative Test

I have adapted the Benedict's test for sugar to be quantitative, allowing for a major upgrade to biology lab activities, and with potential medical uses.

Laura Balagot

Cypress College
Mentor: Kendyl Covey

Bee-Gone Bacteria: Learning from Ancient Medicine and How it Relates to Modern Antibiotic Overuse

Preliminary clinical evidence proposes honey as a potential antimicrobial agent; on a larger scale, this could be a cost effective and easily accessible medical treatment.

Session 4: Oral Presentations

2:15-3:30 pm

SSC MPR 1

Joe Wilson

MiraCosta College

Mentor: Christopher Sleeper

The Only Good Pirate is a Dead Pirate: Freedom in the Golden Age of Piracy and the Empire Who Ended It

A study of the culture and social contract of pirates during the Golden Age of Piracy.

Sebastian Salvucci

Irvine Valley College

Mentor: Lewis Long

The Apology Stalemate: South Korea's Long Standing Dissatisfaction with Apologies for Japan's Colonial Abuses

This paper will investigate the apology stalemate between Japan and South Korea for the Korean Colonial Occupation (1910-1945) to understand potential solutions for the future.

Alyssa Puentes

San Bernardino Valley College

Mentor: Edward Gomez

Native Americans' Ongoing Conflict to Maintain their Rights and Culture

After the Indian Civil Rights Act of 1968, Native Americans have continuously fought to retain their sovereignty, treaty rights, and individual cultures.

Juanita Lorenzo-Ruiz

San Bernardino Valley College

Mentor: Edward Gomez

The Dismissal of Native American Remedies

Despite Western medicine's original dismissal of Native remedies, in the 1960s re-examination of these cures sparked modern medicine research and acceptance to incorporate.

Session 4: Oral Presentations

2:15-3:30 pm

SSC MPR 2

Chloe Dang

Pasadena City College
Mentor: Kathleen Green

The Cost of Flying Solo: The Economics of Single-Pilot Operations

The economics of single-pilot operations, referring to commercial airplanes flown by one pilot, are researched to challenge the rhetoric that they are profitable for airlines.

Vanessa Marquez

Long Beach City College
Mentor: Jeff Wheeler

How Does Household Income Affect Work-Life Balance and Divorce Rates

This study explores how state median income affects work-life balance and divorce rates, finding a positive correlation between income and both variables.

Jaymee Navarro

Long Beach City College
Mentor: Geetha Rajaram

Does Health Insurance Matter? A Study of Cancer Mortality

This study examines the impact of insurance type on cancer mortality. Creating a regression analysis on Kaiser data, it found private insurance reduces cancer deaths.

Mateo Alcocer

LA Pierce College
Mentor: Denise Robb

Money Won't Let Them Walk: How Economic Policies Fail Disabled Individuals and What We Can Do About It

How the healthcare system heightens economic discrimination by increasing costs and reducing access for disabled people. This paper proposes equitable policy reforms for health justice.

Session 4: Oral Presentations

2:15-3:30 pm

SSC MPR 3

Khaalisah Grzegorzcyk
Citrus College
Mentor: Jennifer Miller-Thayer

Campus Protests and Punishments: How the Ongoing Isreal-Palestine Conflict Shapes the Sociopolitical Landscape of University Activism

This paper examines the punitive measures taken on faculty and students who participated in pro-Palestinian protests and its implications on censorship and critical thinking.

Seiji Sakamoto
Pasadena City College
Mentor: Amy Coren

Impact of Perceived Financial Insecurity on Academic Performance and Student Well-Being

In today's educational climate, students are increasingly under financial stress. This study examines the relationship between perceived financial insecurity and students' academic performance and well-being.

Edith Aguilar
Los Angeles Harbor College
Mentor: Joachin Arias

Chronic Stress and Mental Health in Post-Secondary Students

Exploring the impact of chronic stress on post-secondary students' mental health, including its primary causes, effects, long-term risks, and solutions at individual and institutional levels.

Gurneet Kaur
Cypress College
Mentor: Kathryn Sonne

Brain-Rot: The Regression of our Minds

Addressing possible solutions to the causation between the prevalent use of AI, specifically in academic writing, and declining cognitive health markers.

Session 4: Oral Presentations

2:15-3:30 pm

SSC 216

Asher Light

Norco College
Mentor: Christopher
Defossez

A Meme is Worth a Thousand Words

This study explores how meme creation and consumption shape political discourse, social identity, and out-group bias, highlighting influences on online behavior and offline social dynamics.

Elizabeth Tagger

Mt. San Antonio College
Mentor: Charis Louie

Filtered Perceptions: Could Social Media Filters Undermine Authenticity And Harm First Impressions?

The use of beauty filters, unexpectedly, negatively influences college students' perceptions of personality traits.

Alim Yai

Irvine Valley College
Mentor: Emily Liu

Deepfake Perception and Awareness: Understanding Public Sentiment and Concerns

My goal was to ascertain the general public's perception, awareness, and detection capacity of deepfakes.

Austin Pagdanganan

Pasadena City College
Mentor: Shane Underwood

The Misconceptions of COVID-19 through X Conspiracy Theories

This paper explores how COVID-19 conspiracy theories on X employ rhetorical strategies to spread health misinformation, influencing public trust in scientific communication, and health-related behaviors.

Session 4: Oral Presentations

2:15-3:30 pm

SSC 235

Kirby Pili

Mt. San Antonio College
Mentor: Sierra Powell

Stars on Screen, Exploited Behind the Scenes: An Examination of the Coogan Law and the Rise of the 'Kidfluencer'

An exploration of the Coogan Law and the challenges of protecting the monetary rights of child performers in a rapidly evolving digital environment.

Jasmine Minchez-Lopez

LA Pierce College
Mentor: Christine Ersig-Marcus

The Performance of Posting: The Commodification of Identity Through Aesthetics on Social Media

While online aesthetics evolved from visualizations of the ideal self, it's created a means for brands to commodify identity which thrives an increasingly image-driven culture.

**Alex Boshara
Cory Kanemoto
Malakai Stokes**

Citrus College
Mentor: Areej Qasqas

Fact & Fiction: Mental Health, Misinformation, and Social Media

Citrus College Phi Theta Kappa HIA's project highlights how social media's impact on college students' mental health through a "Mental Health Exchange."

Adamary Cantillano

LA Pierce College
Mentor: Christine Ersig-Marcus

On the Detrimental Effects of Social Media on Romantic Relationships

Our romantic relationships are being damaged with the avenues social media provides for detrimental behaviors that change how we view our partners and our relationships.

Session 4: Oral Presentations

2:15-3:30 pm

SSC 308

Grant Yong

Las Positas College
Mentor: Irena Keller

The Role of Music in Shaping Brain Function

Classical music soothes, while rock amplifies arousal—this study unveils music's power to shape emotions, perceived stress, and physiological change during cognitive tasks.

Isabella Dimeo

El Camino College
Mentor: William Doyle

The Psychology Behind Lofi Enhancing Sleep

Lofi music's slow tempo, warm timbre, and texture filled with white noise and natural sounds make it the perfect genre for sleep.

Marie Beccue

Long Beach City College
Mentors: R. Hollenberg and
Jeffrey Douglas

What If the Voices in your Head Were Real? A Conceptual Analysis of Voice Hearing Phenomena on a Spectrum from Iatrogenic Harm to Social Agency

A conceptual analysis of voice hearing modalities across cultures, pinpointing the critical role of social acceptance versus pathologization in the development of psychotic illness.

David Tolman

Los Angeles City College
Mentor: Lauren
Hofschneider

Aphantasia and Vocational Outcomes

Visualizing Futures: Students with aphantasia are less likely to pursue degrees and careers in visually demanding fields such as architecture and design.

Session 4: Oral Presentations

2:15-3:30 pm

SSC 316

William Nunez De La O
Cypress College
Mentor: Sandra Rocha

Using Nile Red Dye to Differentiate A β 40 and A β 42: Imaging Molecular Differences in Understanding Alzheimer's Disease

Using Nile Red dye and super-resolution microscopy, our research identifies structural differences between A β 40 and A β 42, advancing Alzheimer's disease imaging and therapeutic strategies.

Zifang Shi
Ofelia Veisalov
Irvine Valley College
Mentor: Meredith Dorner

Exploring Therapeutic Approaches to Tau Pathology in Alzheimer's Disease: Targeting UPR, Proteasome Dysfunction, Blood Plasma, and mTOR Pathway

This study investigates Alzheimer's disease, exploring therapeutic strategies targeting UPR, proteasome dysfunction, blood plasma treatment, and mTOR pathway to reduce tau burden and improve cognition.

Neika Daftari
Irvine Valley College
Mentor: Michael Sawitz

Research in the Controllable Variables of Dementia Onset: Medical Device Enhancements

I am creating a medical device company which aims to create dementia preventative products. Currently, I have created 'Hearing Helper'; a modified hearing aid alternative.

Jesus Estrada
Pasadena City College
Mentor: Caroline LaMonda

The Biology, Anatomy, and Physiology of the Schizophrenic Brain

In mainstream media, schizophrenia has been regarded as a disorder of hallucinations both visual and auditory. This is true however, there is more to consider.

Session 4: Oral Presentations

2:15-3:30 pm

SSC 329

Aagneya Shrivastav

Chaffey College
Mentor: Daniel Carson

Significance and Evolution of Gravitational Wave Detection

A chronological exploration of Gravitational Waves from their prediction via Einstein's Field Equation to current and future detection technology along with new findings.

**Savanna Campbell
Shubham Waldiya**

El Camino College
Mentor: Mitchell Middler

Comparing Architectures of Kolmogorov Arnold Networks and Multi-Layer Perceptron Networks

This project explores the benefits and shortcomings of Kolmogorov Arnold Networks (KAN), by comparing its performance with that of a traditional neural network.

Cindy Phan

Irvine Valley College
Mentor: Andrian Nguyen

Natural Language Processing for Automated Eye Health Record Analysis

This research investigates the use of Natural Language Processing (NLP) to automate the collection and interpretation of critical clinical data from ophthalmic electronic health records.

Session 4: Oral Presentations

2:15-3:30 pm

SSC 335

Jackson Reeve
Max Hernandez
Benjamin Villa
Fullerton College
Mentor: Esteban Lara

The Economic Effects of the Online Market

The introduction of online shopping has revolutionized global consumerism immensely. This study examines the effects of e-commerce on consumers, firms, and the nationwide economy.

Lena Nguyen
Ellyza Quiaf
Irvine Valley College
Mentor: Bennet Tchaikovsky

Revisiting the Past: How Nostalgic Marketing Evokes Positive & Negative Emotions to Influence Millennial and Gen Z Consumer Behavior

Study examines the positive and negative impact of nostalgic brands on Gen Z and Millennial purchasing behavior through consumer loyalty and emotional connectedness.

Collin Nguyen
Manas Mapuskar
Irvine Valley College
Mentor: Adam Ghuloum

How Retail Investors, Online Communities, and Meme Culture are Disrupting Modern Finance

This project explores the interaction of digital communities on social media to reveal what allows retail investors to make large-scale disruptions to traditional financial systems.

Siddhanth Bangalore Ravi
Los Angeles Harbor College
Mentor: Joachin Arias

Leveraging Central Bank Digital Currencies (CBDCs) to Foster Economic Stability in Developing Economies

Central bank digital currencies can stabilize and grow developing economies by providing financial inclusivity, transparency, and stability while lowering costs with careful consideration of implementation.

Closing Plenary / Awards

3:45-4:30 pm

HUB 302

HTCC Director's Award

Every year, HTCC recognizes a former honors program leader for their contributions to community college honors education. The recipient of the Director's Award announces the first-place winner among the Outstanding Abstract Awards.

This year's Director's Award goes to Kathy Patterson.

Kathy Patterson, Santa Ana College

Kathy Patterson taught English at Santa Ana College for 29 years. In addition to teaching, she served as the Honors Transfer Program Coordinator for over 20 years and as co-advisor for Alpha Gamma Sigma and Sigma Kappa Delta for more than 10 years. Kathy was a dedicated and passionate supporter of the Honors Program, pushing students to be their very best. She worked with the HTCC community in a variety of ways. She was a friendly and helpful one-woman welcoming committee, a resourceful and knowledgeable mentor, and reliable Conference Registration Co-Chair. Kathy was often the first to welcome and offer guidance to new Honors Directors, encouraging them to reach out for questions or advice. During monthly HTCC meetings, Kathy was always an active participant, sharing exciting ideas for program promotion or debating the merits of program policies. Kathy never shied away from sharing her opinion, and her students and colleagues were the better for it. Her wisdom, straightforward approach to college politics, and unwavering support of honors students was an inspiration to those who were lucky to know her. Her legacy lives on in the faculty she worked with and the students she championed during her decades-long career in education. We are excited to acknowledge all her contributions to community college honors education by honoring her today with the Director's Award.



Closing Plenary / Awards

3:45-4:30 pm

HUB 302

Outstanding Poster Awards

Posters are judged on visual presentation, creativity, originality and reflection of sound scholarship. First, second, and third-place awards will be given for research posters in two categories, based on discipline.

Outstanding Abstract Awards

Outstanding abstract awards are presented to oral presenters who have submitted top-rated abstracts describing their research projects. The abstracts are judged on organization, quality of writing, and originality and importance of the research. The most highly ranked Outstanding Abstract earns the HTCC Director's Award.

HTCC Director's Award

The Honors Transfer Council of California confers its Directors Award annually to the student who has submitted the finest presentation abstract and has been judged as exemplifying the qualities of an outstanding honors student. The Director's Award is presented by a former honors program leader who HTCC recognizes for their contributions to community college honors education.

Exemplary Achievement Scholarships

The Honors Transfer Council of California gives awards to students graduating this year who show extraordinary achievement in scholarship, especially related to performance in an honors program. Students must be nominated by their honors director. These students display exceptional perseverance in overcoming obstacles to success in college or in an honors program. They have given outstanding service to their college or community or distinguished themselves as leaders in cultural or athletic activities. Finally, their application essays reveal a high quality of thought and expression.

Juan Lara Memorial Scholarship

Dr. Juan Lara created a scholarship to give special honor to a student who has overcome great financial, personal, cultural, or other obstacles to achieve significant success as an honors student. Candidates have been nominated by their honors directors for the Exemplary Achievement Scholarship. With this award, we also honor the memory of Juan Lara, former Assistant Vice Chancellor of UC Irvine, who was always a generous supporter of this conference and of our efforts to serve community college honors students. As an energetic and inspirational Director for the UCI Center for Educational Partnerships, Dr. Lara created opportunities for countless non-traditional students, leading them to seek – and attain – the highest success in their academic lives and career.

Conference Publication: *Building Bridges*

Every year, the HTCC publishes its award-winning abstracts as well as others submitted for publication. Submissions can be made after the conference during the spring semester. Contact Tim Adell at Tim.Adell@vvc.edu for information.

Final Thanks

We thank all of you who shared your research with us today! Thank you to our intrepid moderators, who made each session more welcoming and well managed. Thank you also to all students, faculty, and administrators who came to hear the best in community college research.

Faculty Mentors

Finally, join us in thanking the faculty who mentored all this research! The individuals below are some of the hardest-working, most dedicated faculty at the California community colleges.

Nerses Abramyan, Pasadena City College

Tim Adell, Victor Valley College

Amir Ahsan, Irvine Valley College

Can Aksoy, Los Angeles City College

Citlalli Anahuac, Riverside City College

Daniel Ante-Contreras, MiraCosta College

Joachin Arias, Los Angeles Harbor

Nicole Ary, Citrus College

Matthew Atkinson, Long Beach City College

Krysten Audibert, Crafton Hills College

Jodi Balma, Fullerton College

Jennifer Baney, Mt. San Jacinto College

James Bany, Moreno Valley College

Morgan Barrows, Saddleback College

Brian Bartelt, Los Angeles City College

Mandi Batalo, San Bernardino Valley College

Patricia Beckmann, Irvine Valley College

Patricia Bellas, Irvine Valley College

Pablo Benalcazar, Polish Academy of Sciences

Bill Billingsley, Saddleback College

Ruth Blandón, East Los Angeles College

Jillian Blatti, Pasadena City College

Howard Blumenfeld, Las Positas College

Segal Boaz, Las Positas College

Michael Bobo, Norco College

T.L. Brink, Crafton Hills College

Lilia Briones, Mt. San Jacinto College

Jessica Budica, Saddleback College

Stephanie Burnham, El Camino College

Scott Cameron, Cerro Coso Community College

Danilo Caputo, Irvine Valley College

Daniel Carson, Chaffey College

Juan Castillejos, MiraCosta College

Diana Churchill, Mt. San Antonio College

Tom Cody, El Camino College

Elena Cole, Las Positas College

Mark Collinson, Irvine Valley College

Kathleen Conner, Mt. San Jacinto College

Amy Coren, Pasadena City College

Alejandro Cortez, Riverside City College

Allen Coson, East Los Angeles College

Kendyl Covey, Cypress College

Sarah Crachiolo-Garcia, Los Angeles City College

Ricardo Crespo, Riverside City College

Andrea Cullinen, Cypress College

Katya De Los Rios, East Los Angeles College

Christopher Defossez, Norco College

Adam de Petris, Irvine Valley College

Melissa DiLorenzo, Chaffey College

Meredith Dorner, Irvine Valley College

Jeffrey Douglas, Long Beach City College

William Doyle, El Camino College

Jacob Drainville, Norco College

Christine Ersig-Marcus, LA Pierce College

Melissa Ferguson, Orange Coast College

Edward Feser, Pasadena City College

Marni Fisher, Saddleback College

Suki Fisher, Saddleback College

Jennifer Floerke, Moreno Valley College

Melissa Fujiwara, El Camino College

Tiffany Gause, Santiago Canyon College

Marissa Gavin, Irvine Valley College

Adam Ghuloum, Irvine Valley College

Heather Gilmore, Crafton Hills College

Kanya Godde Chrisco, Moreno Valley College

Edward Gomez, San Bernardino Valley College

Carrie Goulding, Irvine Valley College

Kathleen Green, Pasadena City College

Faculty Mentors

Finally, join us in thanking the faculty who mentored all this research! The individuals below are some of the hardest-working, most dedicated faculty at the California community colleges.

Katlyn Greiner, Long Beach City College
Monica Gutierrez, Norco College
Michael Harnett, Glendale College
Erin Hayes, LA Pierce College
Christina Heisser, Los Angeles City College
Amy Hellman, Orange Coast College
Nate Hertweck, Long Beach City College
Anwar Hijaz, Saddleback College
Amy Himsel, El Camino College
Vanesse Hiten, Mt. San Jacinto College
Tanya Hoerer, Orange Coast College
Lauren Hofschneider, Los Angeles City College
R. Hollenberg, Long Beach City College
Bryant Horowitz, East Los Angeles College
Bradley Hughes, Chaffey College
Brandee Idleman, Irvine Valley College
Jeff Ihara, MiraCosta College
Carol Impara, Mt. San Antonio College
Shayda Jalali, Pasadena City College
Kiandra Jimenez, Norco College
Rebecca Johannsen, Pasadena City College
Jeffrey Johnson, Irvine Valley College
Bradford Johnston, Pasadena City College
Stephanie Keefer, Santa Ana College
Irena Keller, Las Positas College
Evan Kendall, Los Angeles City College
Brian Kennedy, Pasadena City College
Meric Keskinel, El Camino College
Vani Khamo, Fullerton College
Joon Kil, Irvine Valley College
Misty Kolchakian, Mt. San Antonio College
Cory Kunkel, Crafton Hills College
Carmen Laguer Díaz, Long Beach City College
Caroline LaMonda, Pasadena City College

Tiffany Lanoix, West Los Angeles College
Esteban Lara, Fullerton College
Alia Latif, LA Pierce College
Katherine LaTourrette, West Los Angeles College
Felipe Leon, El Camino College
Emily Liu, Irvine Valley College
Lewis Long, Irvine Valley College
Federico Lopez Borghesi, Las Positas College
Katie Lookholder, Pasadena City College
Charis Louie, Mt. San Antonio College
Hannah Lucas, Chaffey College
Amitesh Maiti, Las Positas College
Mora Mattern, El Camino College
Darcie McClelland, El Camino College
Shawn McEachin, El Camino College
Moises Medina, Santa Ana College
Mitchell Middler, El Camino College
Jennifer Miller-Thayer, Citrus College
Vered Mirmovitch, West Los Angeles College
Benjamin Mitchell, El Camino College
Ankita Mohapatra, Cal State Fullerton
David Montelongo, Las Positas College
Christina Moorhead, Long Beach City College
Kyle Muldrow, Long Beach City College
Allison Murray, Long Beach City College
Andrian Nguyen, Irvine Valley College
Shellie Ochi, Irvine Valley College
Guck Ooi, Cerro Coso Community College
Erik Ozolins, Mt. San Jacinto College
Teresa Palos, El Camino College
Dan Peace, Mt. San Jacinto College
Julie Peggarr, Mt. San Jacinto College
Lan Pham, Irvine Valley College
Victor Pham, Irvine Valley College

Faculty Mentors

Finally, join us in thanking the faculty who mentored all this research! The individuals below are some of the hardest-working, most dedicated faculty at the California community colleges.

Sean Phommasaysy, Los Angeles City College
Janine Pliska, Long Beach City College
Michael Plotkin, Mt. San Jacinto College
Felipe Ponce, Las Positas College
Sierra Powell, Mt. San Antonio College
Matthew Powell-Palm, Texas A&M University
Areej Qasqas, Citrus College
Geetha Rajaram, Long Beach City College
Nick Reeves, Mt. San Jacinto College
Liesel Reinhart, Pasadena City College
Tim Revell, Mt. San Antonio College
Regina Rhymes, Cypress College
Melissa Rifino Juarez, Rio Hondo College
Basemeh Rihan, Mt. San Jacinto College
Denise Robb, LA Pierce College
Sandra Rocha, Cypress College
Josie Rojas, Los Angeles Harbor
Robin Roy, Las Positas College
Michael Salviani, Irvine Valley College
Michael Sawitz, Irvine Valley College
Laura Scavuzzo Wheeler, Long Beach City College
Deanna Scherger, Irvine Valley College
David Sedghi, Los Angeles City College
Claudia Sellers, Cerro Coso Community College
Stella Setka, West Los Angeles College
Aviral Shrivastava, MiraCosta College
Surana Singh, East Los Angeles College
Kristen Skjonsby, Irvine Valley College
Christopher Sleeper, MiraCosta College
Julie Song, Chaffey College
Kathryn Sonne, Cypress College
Heather Stark, MiraCosta College
Michelle Stewart, Mt. San Jacinto College
Joann Stock, Pasadena City College
Jensea Storie, Mt. San Jacinto College
Karl Striepe, El Camino College
Anthony Szczurek, Saddleback College
Erin Tate, Citrus College
Bennet Tchaikovsky, Irvine Valley College
Daniel Topete, Riverside City College
John Torres, Mt. San Jacinto College
Allison Tripp, Chaffey College
Lynn Trzoss, MiraCosta College
Shane Underwood, Pasadena City College
David Uranga, Pasadena City College
Soraira Urquiza, Los Angeles City College
Michael Vendrasco, Pasadena City College
Kristen Venegas, Irvine Valley College
Karla Villatoro, El Camino College
My Vo Luong, Irvine Valley College
Stacey von Winckelmann, MiraCosta College
Lori Walker, Mt. San Antonio College
Krista Walter, Pasadena City College
Jeff Wheeler, Long Beach City College
Hailey White, Irvine Valley College
Karen Whitney, El Camino College
Rachel Williams, El Camino College
Melissa Wilson, Norco College
Carmen Wimsatt, LA Pierce College
Kassia Wosick, El Camino College
Christina Yamanaka-VU, Mt. San Jacinto College
Cameron Young, Norco College
Jacqueline Yu, Pasadena City College
Roy Zipstein, Irvine Valley College
Desiree Zuniga, Pasadena City College